

OWNER'S MANUAL



Heavy Duty Walkie Stacker
w/Reach and Tilt Feature

3000 lb Capacity

TABLE OF CONTENTS

1. Receipt Inspection.....	
2. Pre-Operational Instructions.....	
3. Safety Information.....	
4. Operating Instructions.....	
4.1 Optional Controls.....	11.
4.2 Basic Operation.....	12.
5. Control System.....	
6. Optional Instrumentation.....	15.
6.3 Hour Meter.....	15.
6.4 BDI and Hour Meter.....	15.
6.5 BDI w/Lock Out.....	16.
7. Drive and Brake.....	
8. Mast and Carriage.....	
9. Hydraulic Adjustments.....	19.
9.1 Lifting Pressure.....	19.
9.2 Lowering Speed.....	19.
10.Planned Maintenance.....	20.
10.1 Lubrication Points.....	21.
10.2 Lubrication Schedule.....	23.
10.3 Hydraulic Reservoir Maintenance.....	24.
10.4 Battery Maintenance.....	25.
10.5 Battery Cable Connections.....	26.
11.Troubleshooting.....	27.
12.Heavy Duty Stacker Parts Listings.....	28.
12.1 General Assembly Parts List.....	30.
12.2 Mast and Carriage Assembly Stage.....	
12.2.1 Mast and Carriage Weldment Stage.....	
12.2.2 Mast and Carriage Weldment Stage.....	
12.2.3 Lift Cylinder Assembly Stage.....	
12.2.4 Chain Assembly Stage.....	
12.2.5 Crosshead Assembly Stage.....	
12.3 Mast and Carriage Assembly Stage.....	
12.3.1 Mast and Carriage Weldment Stage.....	
12.3.2 Mast and Carriage Weldment Stage.....	
12.3.3 Lift Cylinder Assembly Stage.....	
12.3.4 Chain Assembly Stage.....	
12.3.5 Crosshead Assembly Stage.....	

10.1 Lubrication Points

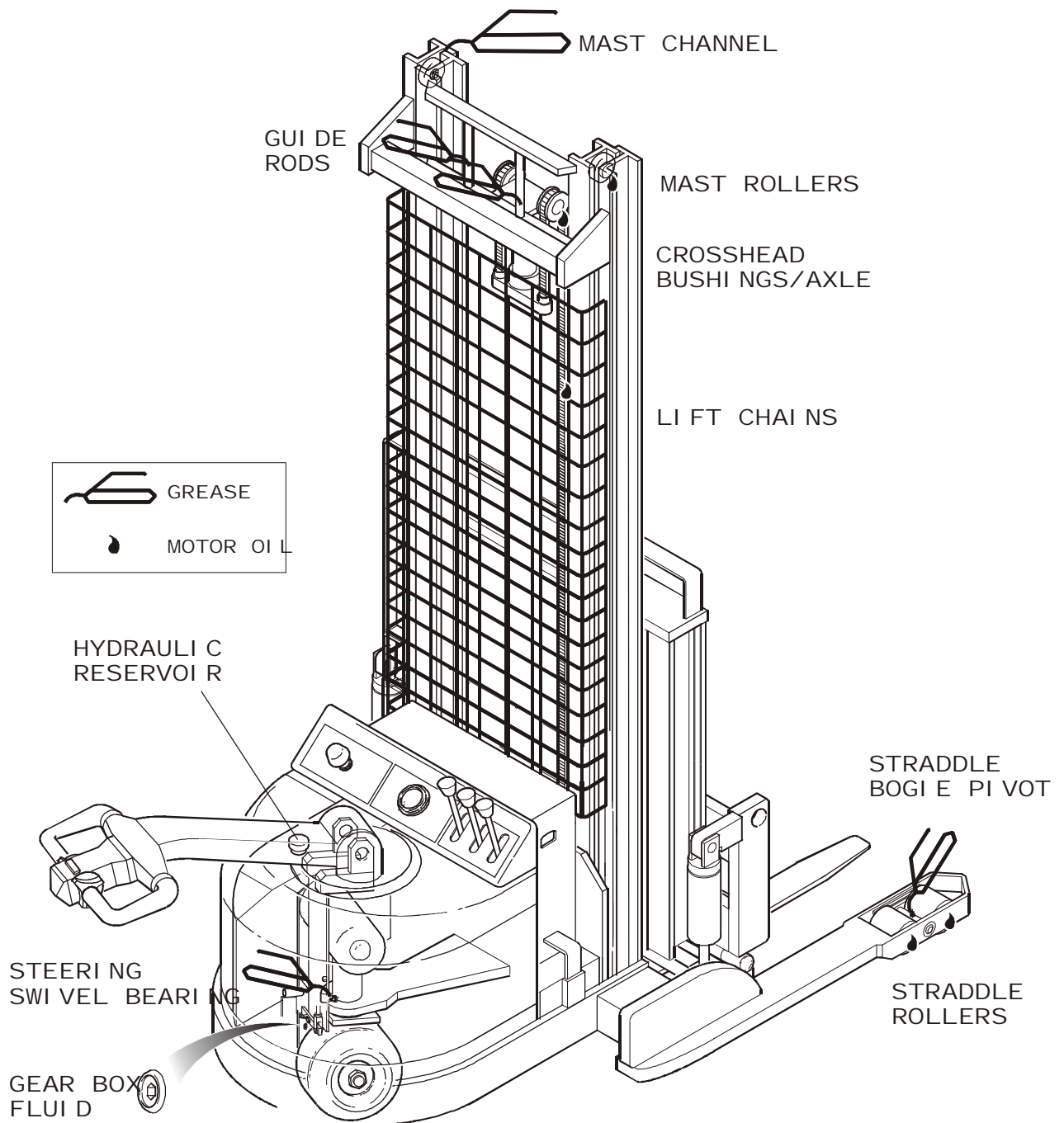

Note: Ball Bearing Style Roller Lubrication.

Figure 9 : Lubrication Points - Body and Mast

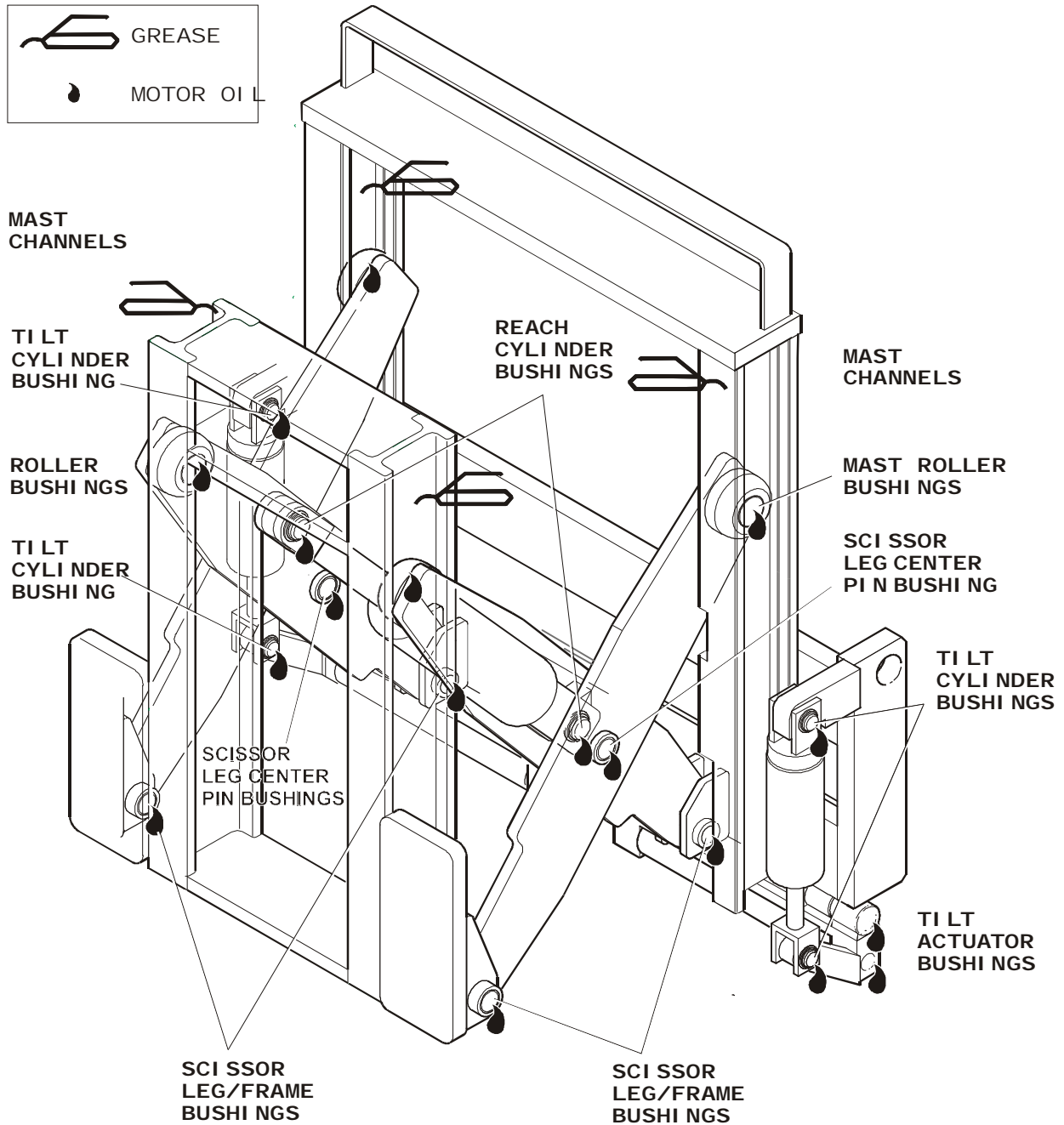

Figure 10 : Lubrication Points - Reach and Tilt Carriage

10.3 Hydraulic Reservoir Maintenance

1. Drain the hydraulic oil from the reservoir by disconnecting the hose at the base of the cylinder.
2. Place the end of the hose end into a collection container.
3. Operate the pump motor by operating the Control Valve (or push button Lift Control if equipped) until no more oil is expelled.
4. Reconnect the hose to the base of the cylinder.
5. Remove the spin-on type oil filter (if equipped) from the return line to the reservoir.
6. Replace the filter with one of the same type. The factory supplied filter has a 10 micron (0.001 inch) bypass rating.
7. Apply a thin coat of hydraulic oil to the filter head.
8. Fill the filter with new hydraulic oil to the filter head.
9. Remove the Drive Unit shroud to expose the hydraulic tank breather cap.
10. Remove the breather cap and refill to the top of the reservoir.

10.4 Battery Maintenance

The Heavy Duty Stacker comes equipped with Industrial Battery and automatic remote charger standard equipment. The battery and charger manufacturers operation manual should be consulted for proper charging, maintenance and handling instructions.

General

The top of the battery should be kept clean. Wash off with clean water and baking soda when necessary. Good ventilation should be provided during charging. Do not allow electrolyte temperature to exceed 110° F (43° C). Keep open flames away from battery. Never add acid to cells. Batteries used at temperatures below or above normal temperature will have reduced capacity.



CAUTION! : DO NOT DISCHARGE SPECIFIC GRAVITY OF 1.150 OR THERE WILL BE A PERMANENT LOSS OF CAPACITY.



WARNING! : ENSURE THAT BATTERY CHARGER ELECTRIC PLUG CANNOT COME INTO CONTACT WITH BATTERY TERMINAL POSTS.



WARNING! : DISCONNECT THE SB BATTERY CONNECTOR FROM THE MACHINE PRIOR TO CHARGING TO PREVENT ACCIDENTAL VEHICLE MOVEMENT.

Batteries requiring maintenance

The following applies to batteries equipped with covers that can be removed for maintenance. Batteries require occasional addition of distilled water to cells.

It is assumed that the personnel performing maintenance are properly trained and authorized so and that procedures are being performed in accordance with battery (and charger) manufacturers maintenance instructions. The said procedures must also be performed in compliance with government regulations (e.g. OSHA, ANSI, etc.).

Do not allow distilled water temperature to exceed 43° C. Keep open flames away from battery. Never add acid to cells. Always add distilled water prior to charging and not after.



WARNING! : PROPER SAFETY DEVICES SUCH AS SAFETY GLASSES, APRON AND GLOVES MUST BE WORN WHEN WORKING WITH BATTERIES.

Records

A weekly record should be kept showing hydrometer readings of pilot cell at start and at end of charge. Change to a different pilot cell monthly. Once a week after the battery has received equalizing charge, record the hydrometer readings of each cell.

Equalizing charge

In order to equalize all the cells once a week after normal charge, the battery should be given an equalizing charge, continued until the improvement between two consecutive hydrometer readings of each cell. This is actually a continuous charge at a low rate.

10.5 Battery Cable Connections



WARNING! : VERIFY PROPER BATTERY VOLTAGE AND POLARITY BEFORE MAKING CONNECTION

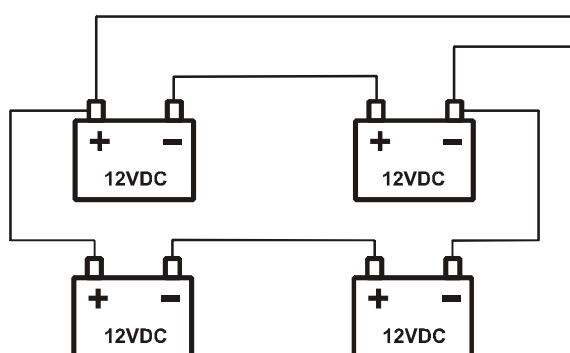

Figure 11 : Typical Cabling Arrangement For 4 - 12 Volt Batteries (With Automatic Built-in Charger pack)

11. Trouble Shooting Guide

The following charts are intended to help identify possible equipment malfunctions.

NOTE: REPAIRS / TROUBLE SHOOTING SHOULD BE PERFORMED BY AN AUTHORIZED TECHNICIAN.

PROBLEM	POSSIBLE CAUSE
NO LIFT (motor does not run)	<ul style="list-style-type: none"> • Discharged battery • Faulty wiring between pump motor and • Faulty contactor for pump motor • Worn out brushes in pump motor • Faulty wiring from battery positive terminal to contactor, or from pump contactor to pump motor • Defective control circuit fuse and/or main p
NO LIFT (motor runs)	<ul style="list-style-type: none"> • Discharged battery • Low hydraulic pressure • Pump check valve stuck open - Faulty solenoi • Check oil level if forks do not raise fully • Foreign material blocking lifting mechanism
FORKS WILL NOT LOWER	<ul style="list-style-type: none"> • Faulty control valve • Obstruction in chain/mast/carriage • Faulty control fuse blown (Push Button Contr • Faulty solenoid coil (Push Button Control On
NO ELECTRICAL POWER or NO TRAVEL	<ul style="list-style-type: none"> • Discharged battery • Loose/corroded battery connections • Blown main or control fuse • Faulty travel control switch • Faulty contactor or contactor tips • Check traction motor • Broken/loose drive belt • Faulty SB connector • Fault detected by controller causing shut do • Faulty Controller • Worn out brushes in pump motor
TRUCK PERFORMS PROPERLY BUT REQUIRES CHARGING FREQUENTLY	<ul style="list-style-type: none"> • Battery being removed from charger before reo • Cycle is completed • Battery water level is too low to accept and • charge • Battery capacity not adequate for workload re • Battery capacity reduced due to battery damage
FORKS WILL NOT LIFT TO FULL HEIGHT PUMP MAKES MORE NOISE THAN NORMAL	<ul style="list-style-type: none"> • Oil level low in Refill Reservoir, determ • area of leakage <p>CAUTION: Use Only recommended oils</p>
LOSS OF BRAKING POWER	<ul style="list-style-type: none"> • Brake requires adjustment. Must be performed • qualified personnel only

NOTE: Additional testing and diagnosis must be performed by authorized service personnel to use of the diagnostics analysis software. Consult the manufacturer or authorized dealer for more details and assistance.

12. Heavy Duty Stacker - Parts Listings

HOW TO USE PARTS LISTINGS

LOCATE THE SERIAL NUMBER PLATE ON THE UNDERSIDE OF THE CONTROL HANDLE, AT THE PIVOT POINT.

UPON RECEIPT OF THE EQUIPMENT COPY THE INFORMATION ON THE SERIAL NUMBER PLATE INTO SECTION 14 : SERVICE HISTORY OF THIS MANUAL FOR QUICK REFERENCE

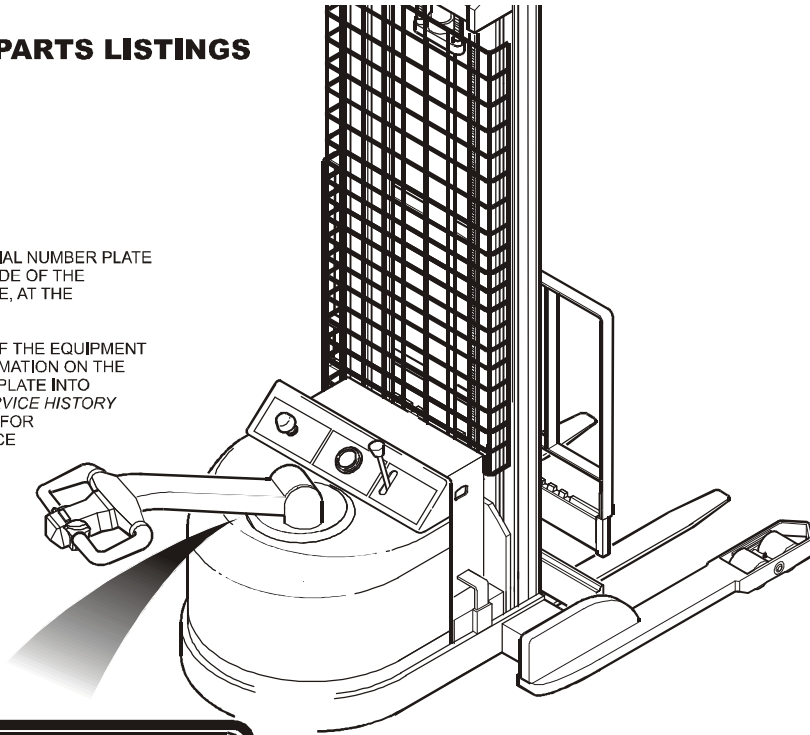

Item	Qty	Description
1	1	103-5021-1
1	1	103-5021-2
1	1	103-5021-3
1	1	103-5021-4
1	1	103-5021-5
1	1	103-5021-6
1	1	103-5021-7
1	1	103-5021-8
1	1	103-5021-9
1	1	103-5021-10
1	1	103-5021-11
1	1	103-5021-12
1	1	103-5021-13
1	1	103-5021-14
1	1	103-5021-15
1	1	103-5021-16
1	1	103-5021-17
1	1	103-5021-18
1	1	103-5021-19
1	1	103-5021-20
1	1	103-5021-21
1	1	103-5021-22
1	1	103-5021-23
1	1	103-5021-24
1	1	103-5021-25
1	1	103-5021-26
1	1	103-5021-27
1	1	103-5021-28
1	1	103-5021-29
1	1	103-5021-30
1	1	103-5021-31
1	1	103-5021-32
1	1	103-5021-33
1	1	103-5021-34
1	1	103-5021-35
1	1	103-5021-36
1	1	103-5021-37
1	1	103-5021-38
1	1	103-5021-39
1	1	103-5021-40
1	1	103-5021-41
1	1	103-5021-42
1	1	103-5021-43
1	1	103-5021-44
1	1	103-5021-45
1	1	103-5021-46
1	1	103-5021-47
1	1	103-5021-48
1	1	103-5021-49
1	1	103-5021-50
1	1	103-5021-51
1	1	103-5021-52
1	1	103-5021-53
1	1	103-5021-54
1	1	103-5021-55
1	1	103-5021-56
1	1	103-5021-57
1	1	103-5021-58
1	1	103-5021-59
1	1	103-5021-60
1	1	103-5021-61
1	1	103-5021-62
1	1	103-5021-63
1	1	103-5021-64
1	1	103-5021-65
1	1	103-5021-66
1	1	103-5021-67
1	1	103-5021-68
1	1	103-5021-69
1	1	103-5021-70
1	1	103-5021-71
1	1	103-5021-72
1	1	103-5021-73
1	1	103-5021-74
1	1	103-5021-75
1	1	103-5021-76
1	1	103-5021-77
1	1	103-5021-78
1	1	103-5021-79
1	1	103-5021-80
1	1	103-5021-81
1	1	103-5021-82
1	1	103-5021-83
1	1	103-5021-84
1	1	103-5021-85
1	1	103-5021-86
1	1	103-5021-87
1	1	103-5021-88
1	1	103-5021-89
1	1	103-5021-90
1	1	103-5021-91
1	1	103-5021-92
1	1	103-5021-93
1	1	103-5021-94
1	1	103-5021-95
1	1	103-5021-96
1	1	103-5021-97
1	1	103-5021-98
1	1	103-5021-99
1	1	103-5021-100

USE MODEL NUMBER/CAPACITY (e.g. XXX30-130 = 3000lb. Capacity w/ 160" LIFT HEIGHT) AND/OR NUMBER OF STAGES TO DETERMINE THE CORRECT PART NUMBER OF A DESIRED ASSEMBLY

ALWAYS QUOTE THIS INFORMATION (ALONG WITH SERIAL NUMBER) WHEN ORDERING PARTS OR REQUESTING TECHNICAL SUPPORT

Heavy Duty Walkie Stacker w/Reach and Tilt Feature

"ASSEMBLIES" ARE PART NUMBERS WITH ADDITIONAL LEVELS - "SUB-ASSEMBLIES" AND ARE INDICATED BY **BOLD TEXT**.

SHORT SUB-ASSEMBLIES ARE INDICATED BY A **SINGLE ASTERISK (*)** IN THE ITEM COLUMN AND ARE **INDENTED** IN THE GENERAL DESCRIPTION COLUMN (IMMEDIATELY FOLLOWING THE PARENT ASSEMBLY)

4	2	103-5031	Assembly Carriage Weld't	3000/40
5	2	103-5031	Driving Pulley	3000/40
6	2	103-5048	Ass'y, Roller - Side Thrust	3000/40
7	2	103-5052	Roller - Side Thrust	3000/40
8	2	103-5051	Roller - Side Thrust	3000/40
9	2	103-5052	Roller - Side Thrust	3000/40
10	2	103-5051	Roller - Side Thrust	3000/40
11	2	103-5051	Roller - Side Thrust	3000/40
12	2	103-5051	Roller - Side Thrust	3000/40
13	2	103-5051	Roller - Side Thrust	3000/40
14	2	103-5051	Roller - Side Thrust	3000/40
15	2	103-5051	Roller - Side Thrust	3000/40
16	2	103-5051	Roller - Side Thrust	3000/40
17	2	103-5051	Roller - Side Thrust	3000/40
18	2	103-5051	Roller - Side Thrust	3000/40
19	2	103-5051	Roller - Side Thrust	3000/40
20	2	103-5051	Roller - Side Thrust	3000/40
21	2	103-5051	Roller - Side Thrust	3000/40
22	2	103-5051	Roller - Side Thrust	3000/40
23	2	103-5051	Roller - Side Thrust	3000/40
24	2	103-5051	Roller - Side Thrust	3000/40
25	2	103-5051	Roller - Side Thrust	3000/40
26	2	103-5051	Roller - Side Thrust	3000/40
27	2	103-5051	Roller - Side Thrust	3000/40
28	2	103-5051	Roller - Side Thrust	3000/40
29	2	103-5051	Roller - Side Thrust	3000/40
30	2	103-5051	Roller - Side Thrust	3000/40
31	2	103-5051	Roller - Side Thrust	3000/40
32	2	103-5051	Roller - Side Thrust	3000/40
33	2	103-5051	Roller - Side Thrust	3000/40
34	2	103-5051	Roller - Side Thrust	3000/40
35	2	103-5051	Roller - Side Thrust	3000/40
36	2	103-5051	Roller - Side Thrust	3000/40
37	2	103-5051	Roller - Side Thrust	3000/40
38	2	103-5051	Roller - Side Thrust	3000/40
39	2	103-5051	Roller - Side Thrust	3000/40
40	2	103-5051	Roller - Side Thrust	3000/40
41	2	103-5051	Roller - Side Thrust	3000/40
42	2	103-5051	Roller - Side Thrust	3000/40
43	2	103-5051	Roller - Side Thrust	3000/40
44	2	103-5051	Roller - Side Thrust	3000/40
45	2	103-5051	Roller - Side Thrust	3000/40
46	2	103-5051	Roller - Side Thrust	3000/40
47	2	103-5051	Roller - Side Thrust	3000/40
48	2	103-5051	Roller - Side Thrust	3000/40
49	2	103-5051	Roller - Side Thrust	3000/40
50	2	103-5051	Roller - Side Thrust	3000/40
51	2	103-5051	Roller - Side Thrust	3000/40
52	2	103-5051	Roller - Side Thrust	3000/40
53	2	103-5051	Roller - Side Thrust	3000/40
54	2	103-5051	Roller - Side Thrust	3000/40
55	2	103-5051	Roller - Side Thrust	3000/40
56	2	103-5051	Roller - Side Thrust	3000/40
57	2	103-5051	Roller - Side Thrust	3000/40
58	2	103-5051	Roller - Side Thrust	3000/40
59	2	103-5051	Roller - Side Thrust	3000/40
60	2	103-5051	Roller - Side Thrust	3000/40
61	2	103-5051	Roller - Side Thrust	3000/40
62	2	103-5051	Roller - Side Thrust	3000/40
63	2	103-5051	Roller - Side Thrust	3000/40
64	2	103-5051	Roller - Side Thrust	3000/40
65	2	103-5051	Roller - Side Thrust	3000/40
66	2	103-5051	Roller - Side Thrust	3000/40
67	2	103-5051	Roller - Side Thrust	3000/40
68	2	103-5051	Roller - Side Thrust	3000/40
69	2	103-5051	Roller - Side Thrust	3000/40
70	2	103-5051	Roller - Side Thrust	3000/40
71	2	103-5051	Roller - Side Thrust	3000/40
72	2	103-5051	Roller - Side Thrust	3000/40
73	2	103-5051	Roller - Side Thrust	3000/40
74	2	103-5051	Roller - Side Thrust	3000/40
75	2	103-5051	Roller - Side Thrust	3000/40
76	2	103-5051	Roller - Side Thrust	3000/40
77	2	103-5051	Roller - Side Thrust	3000/40
78	2	103-5051	Roller - Side Thrust	3000/40
79	2	103-5051	Roller - Side Thrust	3000/40
80	2	103-5051	Roller - Side Thrust	3000/40
81	2	103-5051	Roller - Side Thrust	3000/40
82	2	103-5051	Roller - Side Thrust	3000/40
83	2	103-5051	Roller - Side Thrust	3000/40
84	2	103-5051	Roller - Side Thrust	3000/40
85	2	103-5051	Roller - Side Thrust	3000/40
86	2	103-5051	Roller - Side Thrust	3000/40
87	2	103-5051	Roller - Side Thrust	3000/40
88	2	103-5051	Roller - Side Thrust	3000/40
89	2	103-5051	Roller - Side Thrust	3000/40
90	2	103-5051	Roller - Side Thrust	3000/40
91	2	103-5051	Roller - Side Thrust	3000/40
92	2	103-5051	Roller - Side Thrust	3000/40
93	2	103-5051	Roller - Side Thrust	3000/40
94	2	103-5051	Roller - Side Thrust	3000/40
95	2	103-5051	Roller - Side Thrust	3000/40
96	2	103-5051	Roller - Side Thrust	3000/40
97	2	103-5051	Roller - Side Thrust	3000/40
98	2	103-5051	Roller - Side Thrust	3000/40
99	2	103-5051	Roller - Side Thrust	3000/40
100	2	103-5051	Roller - Side Thrust	3000/40

LARGE SUB-ASSEMBLIES REQUIRING SEPARATE PAGES ARE INDICATED BY A **DOUBLE ASTERISK (**)** IN THE ITEM COLUMN. THESE SUB-ASSEMBLIES WILL APPEAR ON SUBSEQUENT PAGES IN THE SAME ORDER THAT THEY APPEAR IN THE PARENT ASSEMBLY

ITEMS IN **PLAIN TEXT** DO NOT CONTAIN ANY ADDITIONAL SUB-ASSEMBLIES, FURTHER SERVICEABLE PARTS, OR ARE NOT SOLD SEPARATELY.

NOTE: SOME SUB-ASSEMBLIES WILL CONTAIN FURTHER SUB-ASSEMBLIES REQUIRING FURTHER PAGES.