



PARTS MANUAL

226 SKID STEER LOADER

5FZ

Tip: Use Bookmarks panel to navigate

Printed by Heavy Equipment Manuals
v2.20

Printed in U.S.A

[Heavy Equipment Manuals](#)

[Previous Screen](#)

Product: NO EQUIPMENT SELECTED
Model: NO EQUIPMENT SELECTED
Configuration: NO EQUIPMENT SELECTED

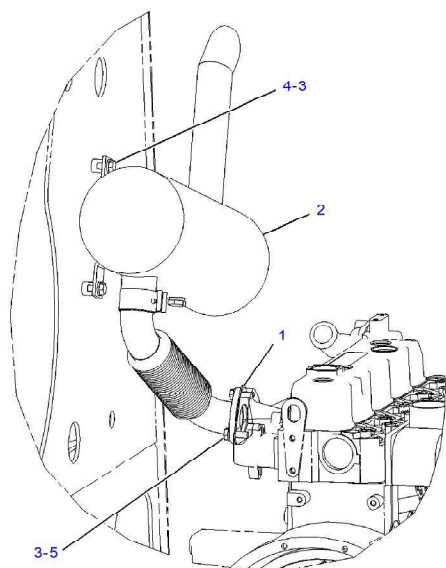

GRAPHIC #1
g00558792

216 226 228 Skid Steer Loader, Powered By 3034 Engine

Media Number - SEBP2849-97 | Publication Date - 01/11/2020 | Date

Updated - 03/11/2020

i01067900

142-8829 MOUNTING GP-MUFFLER

S/N 4NZ1-3399; 5FZ1-6699; 6BZ1-699

PART OF 142-8705, 187-1259 INSTALLATION AR-ENGINE

ENTIRE GROUP

Ref.	Qty.	NPR Note	Part No.	Part Name
Grp	<input type="text"/>	NPR	142-8829	MOUNTING GP-MUFFLER

INDIVIDUAL PARTS

Ref.	Qty.	NPR Note	Part No.	Req. Qty.	Part Name
1	<input type="text"/>	NPR	140-2349	1	GASKET

2	<div></div>	NPR Y	<u>142-8852</u>	1	MUFFLER GP
3	<div></div>	NPR	8T-4121	7	WASHER-HARD (11X21X2.5-MM THK)
4	<div></div>	NPR M	8T-4137	4	BOLT (M10X1.5X20-MM)
5	<div></div>	NPR M	8T-4195	3	BOLT (M10X1.5X30-MM)

Key:

M - METRIC PART
Y - SEPARATE ILLUSTRATION

SMCS Codes		
1062		

[Previous Screen](#)

Product: NO EQUIPMENT SELECTED
Model: NO EQUIPMENT SELECTED
Configuration: NO EQUIPMENT SELECTED

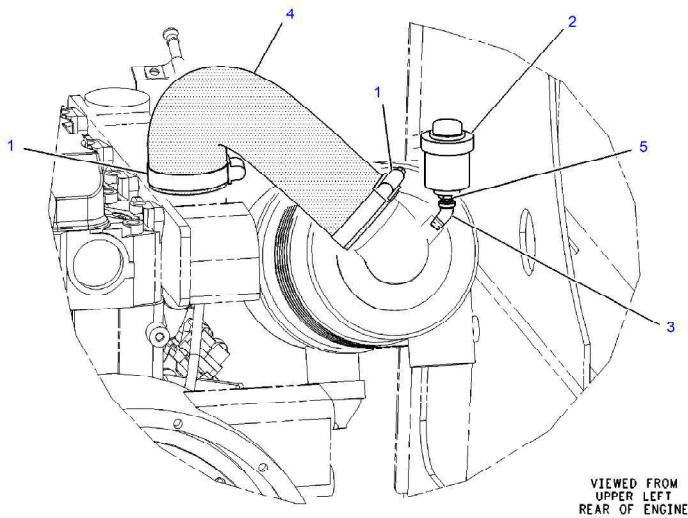

GRAPHIC #1
g00599767

216 226 228 Skid Steer Loader, Powered By 3034 Engine
Media Number - SEBP2849-97 | Publication Date - 01/11/2020 | Date
Updated - 03/11/2020

i03889349

142-8851 LINES GP-AIR
S/N 4NZ1-3399; 5FZ1-6699; 6BZ1-699
PART OF 142-8705, 187-1259 INSTALLATION AR-ENGINE

ENTIRE GROUP

Ref.	Qty.	NPR Note	Part No.	Part Name
Grp	<input type="text"/>	NPR	142-8851	LINES GP-AIR

INDIVIDUAL PARTS

Ref.	Qty.	NPR Note	Part No.	Req. Qty.	Part Name
1	<input type="text"/>	NPR	5P-4868	2	CLAMP-HOSE

2		NPR	150-5030	1	INDICATOR-AIR FILTER CHANGE
3		NPR	8L-5008	1	ELBOW-PIPE
4		NPR	142-8849	1	HOSE
5		NPR	169-6713	1	ADAPTER AS
		NPR	7J-0204	1	SEAL-O-RING

SMCS Codes		
1071		

[Previous Screen](#)

Product: NO EQUIPMENT SELECTED
Model: NO EQUIPMENT SELECTED
Configuration: NO EQUIPMENT SELECTED

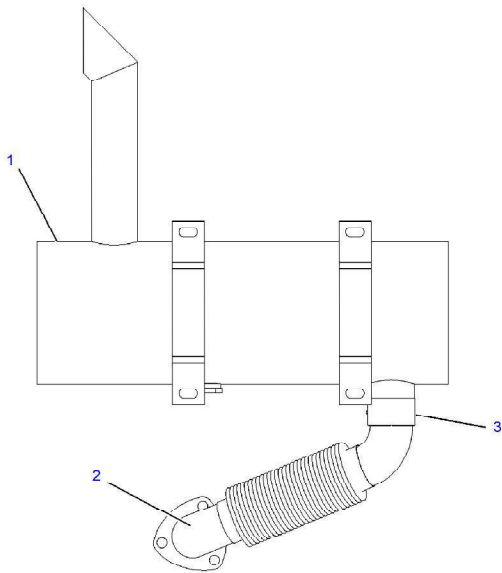

GRAPHIC #1
g00677846

216 226 228 Skid Steer Loader, Powered By 3034 Engine
Media Number - SEBP2849-97 | Publication Date - 01/11/2020 | Date
Updated - 03/11/2020

i01277855

142-8852 MUFFLER GP
S/N 4NZ1-3399; 5FZ1-6699; 6BZ1-699
PART OF 142-8829 MOUNTING GP-MUFFLER

ENTIRE GROUP

Ref.	Qty.	NPR Note	Part No.	Part Name
Grp	<input type="text"/>	NPR	142-8852	MUFFLER GP

INDIVIDUAL PARTS

Ref.	Qty.	NPR Note	Part No.	Req. Qty.	Part Name
1	<input type="text"/>	NPR	142-8811	1	MUFFLER AS

[Previous Screen](#)

Product: NO EQUIPMENT SELECTED
Model: NO EQUIPMENT SELECTED
Configuration: NO EQUIPMENT SELECTED

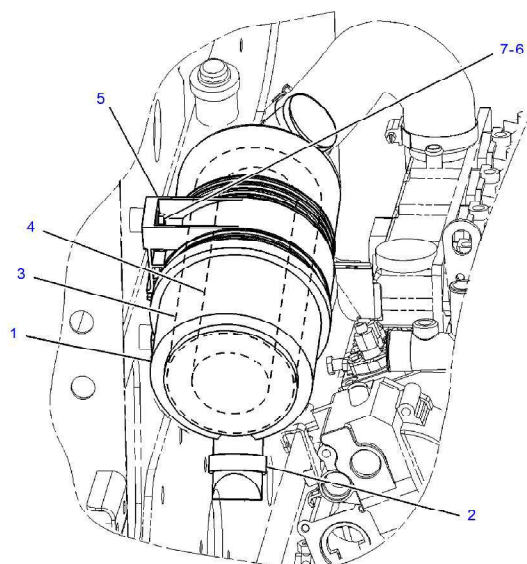

GRAPHIC #1
g00559501

216 226 228 Skid Steer Loader, Powered By 3034 Engine
Media Number - SEBP2849-97 | Publication Date - 01/11/2020 | Date
Updated - 03/11/2020

i04282609

142-8857 AIR CLEANER GP
S/N 4NZ1-3399; 5FZ1-6699; 6BZ1-699
PART OF 142-8705, 187-1259 INSTALLATION AR-ENGINE

ENTIRE GROUP

Ref.	Qty.	NPR Note	Part No.	Part Name
Grp	<input type="text"/>	NPR	142-8857	AIR CLEANER GP

INDIVIDUAL PARTS

Ref.	Qty.	NPR Note	Part No.	Req. Qty.	Part Name
1	<input type="text"/>	NPR	140-2331	1	AIR CLEANER GP

2	<input type="text"/>	NPR	112-9717	1	VALVE-DUST (AIR CLEANER)
3	<input type="text"/>	NPR	134-8726	1	FILTER ELEMENT AS-AIR (PRIMARY)
4	<input type="text"/>	NPR	140-2334	1	FILTER ELEMENT AS-AIR (SECONDARY)
5	<input type="text"/>	NPR	152-4891	1	BAND-MOUNTING
6	<input type="text"/>	NPR	5P-4116	2	WASHER-HARD (8.8X20.5X2-MM THK)
7	<input type="text"/>	NPR M	8T-4908	2	BOLT (M8X1.25X25-MM)

Key:

M - METRIC PART

SMCS Codes		
1051	1054	

[Previous Screen](#)

Product: NO EQUIPMENT SELECTED
Model: NO EQUIPMENT SELECTED
Configuration: NO EQUIPMENT SELECTED

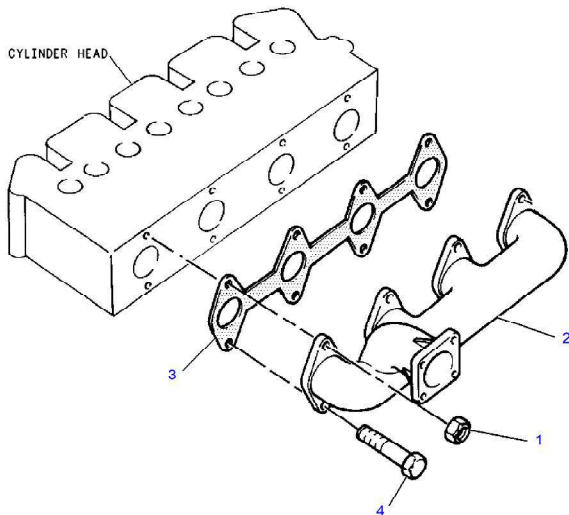

GRAPHIC #1
g00483759

216 226 228 Skid Steer Loader, Powered By 3034 Engine
Media Number - SEBP2849-97 | Publication Date - 01/11/2020 | Date
Updated - 03/11/2020

i02644037

160-3568 MANIFOLD GP-EXHAUST
S/N GGA1-UP; CSD1-UP
PART OF 179-1808 ENGINE AR-PRIMARY
AN ATTACHMENT

ENTIRE GROUP

Ref.	Qty.	NPR Note	Part No.	Part Name
Grp	<input type="text"/>		160-3568	MANIFOLD GP-EXHAUST

INDIVIDUAL PARTS

Ref.	Qty.	NPR Note	Part No.	Req. Qty.	Part Name
1		<u>NPR</u> M	153-5592	2	NUT (M8X1.25-THD)