



PARTS MANUAL

262C2 SKID STEER LOADER

TMW00001-UP

Tip: Use Bookmarks panel to navigate

Printed by Heavy Equipment Manuals
v2.20

Printed in U.S.A

[Heavy Equipment Manuals](#)

Previous Screen

Product: SKID STEER LOADER
 Model: 262C2 SKID STEER LOADER TMW
 Configuration: 262C2 Skid Steer Loader TMW00001-UP (MACHINE)
 POWERED BY C3.4 Engine

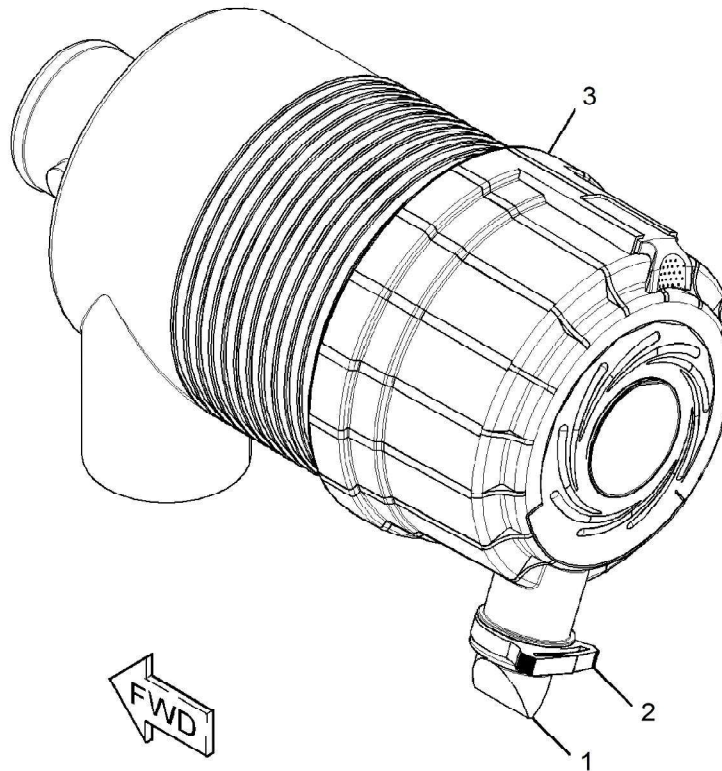

GRAPHIC #1
 g01352945

262C2 Skid Steer Loader, Powered By C3.4 Engine
 Media Number - SEBP5932-13 | Publication Date - 01/02/2018 | Date
 Updated - 09/02/2018

i03552762

258-3320 AIR CLEANER GP
S/N TMW1-UP
PART OF 258-3453 AIR CLEANER GP
Type 1

ENTIRE GROUP

Ref.	Qty.	NPR Note	Part No.	Part Name
Grp	<input type="text"/>	NPR	258-3320	AIR CLEANER GP

INDIVIDUAL PARTS

Ref.	Qty.	NPR Note	Part No.	Req. Qty.	Part Name
------	------	----------	----------	-----------	-----------

1		NPR	112-9717	1	VALVE-DUST (AIR CLEANER)
2		NPR	280-8298	1	CLAMP
3		NPR	280-8302	1	COVER AS
		NPR F	110-6326	1	FILTER ELEMENT AS-AIR (PRIMARY)
		NPR F	110-6331	1	FILTER ELEMENT AS-AIR (SECONDARY)

Key:

F - NOT SHOWN

SMCS Codes		
1051	1054	

Previous Screen

Product: SKID STEER LOADER
 Model: 262C2 SKID STEER LOADER TMW
 Configuration: 262C2 Skid Steer Loader TMW00001-UP (MACHINE)
 POWERED BY C3.4 Engine

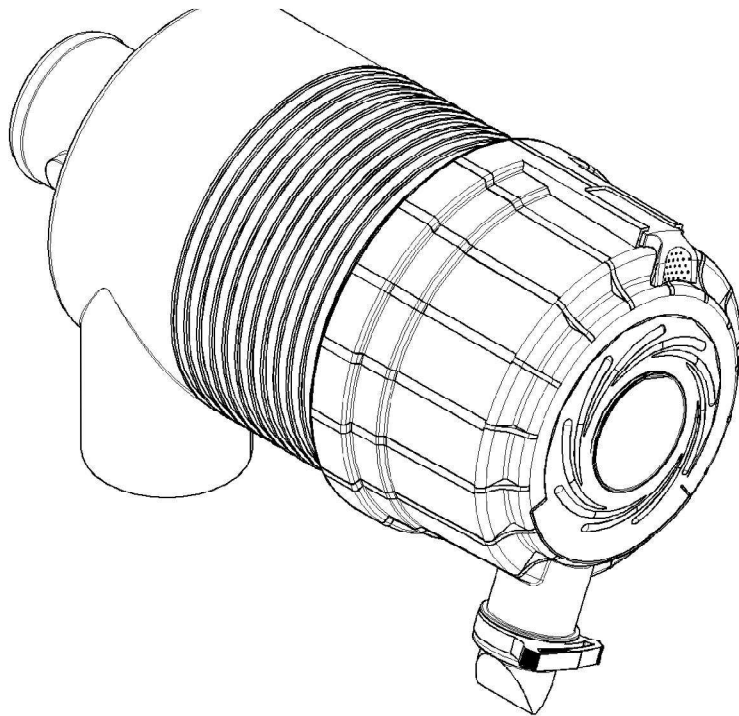

GRAPHIC #1
 g03679044

262C2 Skid Steer Loader, Powered By C3.4 Engine

Media Number - SEBP5932-13 | Publication Date - 01/02/2018 | Date
 Updated - 09/02/2018

i05769190

258-3320 AIR CLEANER GP

S/N TMW1-UP

PART OF 258-3453 AIR CLEANER GP

Type 2

ENTIRE GROUP

Ref.	Qty.	NPR Note	Part No.	Part Name
Grp	<input type="text"/>	NPR	258-3320	AIR CLEANER GP

INDIVIDUAL PARTS

Ref.	Qty.	NPR Note	Part No.	Req. Qty.	Part Name
------	------	----------	----------	-----------	-----------

(NO SERVICED PARTS)

	NPR AF	110-6326	1	FILTER ELEMENT AS-AIR (PRIMARY)
	NPR AF	110-6331	1	FILTER ELEMENT AS-AIR (SECONDARY)
	NPR AF	112-9717	1	VALVE-DUST (AIR CLEANER)
	NPR AF	280-8302	1	COVER AS

Key:

A - NOT PART OF THIS GROUP

F - NOT SHOWN

SMCS Codes		
1051	1054	

Copyright 1993 - 2023 Caterpillar Inc.
All Rights Reserved.
Private Network For SIS Licensees.

Thu Aug 24 2023 21:04:38 GMT+0530 (India Standard Time)

Previous Screen

Product: SKID STEER LOADER
 Model: 262C2 SKID STEER LOADER TMW
 Configuration: 262C2 Skid Steer Loader TMW00001-UP (MACHINE)
 POWERED BY C3.4 Engine

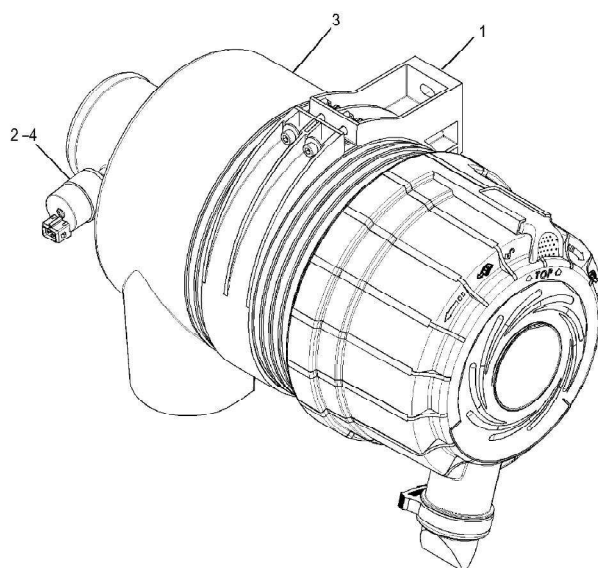

GRAPHIC #1
 g03736579

262C2 Skid Steer Loader, Powered By C3.4 Engine

Media Number - SEBP5932-13 | Publication Date - 01/02/2018 | Date
 Updated - 09/02/2018

i06258332

258-3453 AIR CLEANER GP

S/N TMW1-UP

PART OF 280-8294 AIR CLEANER GP

ENTIRE GROUP

Ref.	Qty.	NPR Note	Part No.	Part Name
Grp	<input type="text"/>	NPR	258-3453	AIR CLEANER GP

INDIVIDUAL PARTS

Ref.	Qty.	NPR Note	Part No.	Req. Qty.	Part Name
1		NPR	152-4898	1	BAND-MOUNTING

2		<u>NPR</u>	237-7325	1 INDICATOR
3		<u>NPR</u> Y	<u>258-3320</u>	1 AIR CLEANER GP
4		<u>NPR</u>	5L-3233	1 FITTING-CONNECTOR

Key:

Y - SEPARATE ILLUSTRATION

SMCS Codes		
1051	1054	

Copyright 1993 - 2023 Caterpillar Inc.
All Rights Reserved.
Private Network For SIS Licensees.

Thu Aug 24 2023 21:05:03 GMT+0530 (India Standard Time)

Previous Screen

Product: SKID STEER LOADER
 Model: 262C2 SKID STEER LOADER TMW
 Configuration: 262C2 Skid Steer Loader TMW00001-UP (MACHINE)
 POWERED BY C3.4 Engine

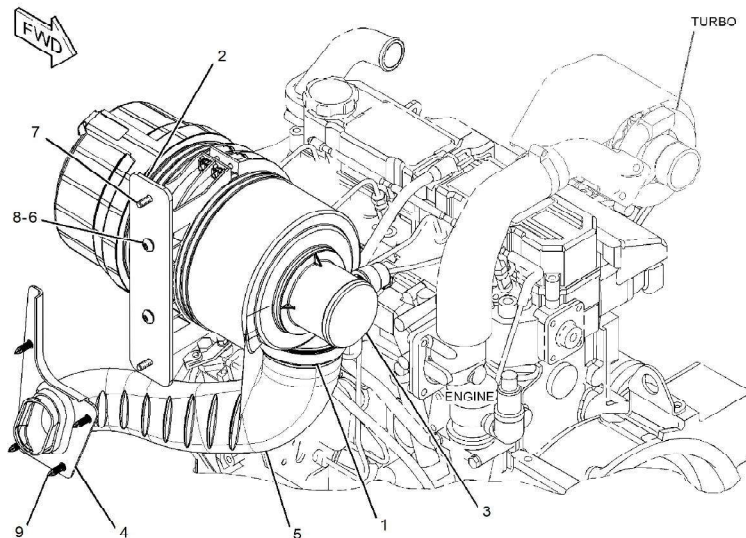

GRAPHIC #1
 g01340060

262C2 Skid Steer Loader, Powered By C3.4 Engine
 Media Number - SEBP5932-13 | Publication Date - 01/02/2018 | Date
 Updated - 09/02/2018

i02663655

280-8294 AIR CLEANER GP
S/N TMW1-UP
PART OF 295-7118 INSTALLATION AR-ENGINE

ENTIRE GROUP

Ref.	Qty.	NPR Note	Part No.	Part Name
Grp	<input type="text"/>	NPR	280-8294	AIR CLEANER GP

INDIVIDUAL PARTS

Ref.	Qty.	NPR Note	Part No.	Req. Qty.	Part Name
1		NPR	131-6143	1	CLAMP-HOSE

2		<u>NPR</u>	258-2511	1	PLATE
3		<u>NPR</u> Y	<u>258-3453</u>	1	AIR CLEANER GP
4		<u>NPR</u>	280-8286	1	COVER
5		<u>NPR</u>	280-8293	1	DUCT
6		<u>NPR</u> M	127-2170	2	SCREW-TRUSS HEAD (M8X1.25X20-MM)
7		<u>NPR</u> M	266-3315	2	BOLT-FLANGE HEAD (M8X1.25X25.5-MM)
8		<u>NPR</u>	8T-4224	2	WASHER-HARD (8.8X16X2-MM THK)
9		<u>NPR</u>	9R-9901	4	FASTENER (CLIP)

Key:

M - METRIC PART

Y - SEPARATE ILLUSTRATION

SMCS Codes		
1051	1054	

Copyright 1993 - 2023 Caterpillar Inc.
All Rights Reserved.
Private Network For SIS Licensees.

Thu Aug 24 2023 21:05:47 GMT+0530 (India Standard Time)

Previous Screen

Product: SKID STEER LOADER
 Model: 262C2 SKID STEER LOADER TMW
 Configuration: 262C2 Skid Steer Loader TMW00001-UP (MACHINE)
 POWERED BY C3.4 Engine

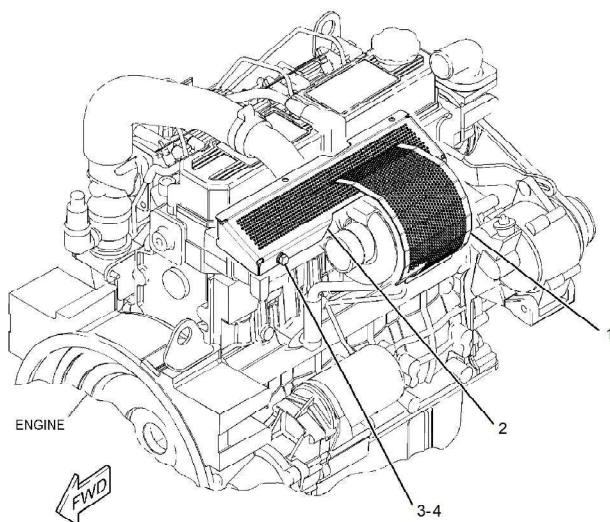

GRAPHIC #1
 g01528728

262C2 Skid Steer Loader, Powered By C3.4 Engine

Media Number - SEBP5932-13 | Publication Date - 01/02/2018 | Date
 Updated - 09/02/2018

i03019204

280-8393 GUARD GP-DEBRIS -TURBOCHARGER, EXHAUST MANIFOLD
S/N TMW1-UP
PART OF 258-3183, 258-3734 HYDRAULIC AR
AN ATTACHMENT

ENTIRE GROUP

Ref.	Qty.	NPR Note	Part No.	Part Name
Grp	<input type="text"/>	NPR	280-8393	GUARD GP-DEBRIS -TURBOCHARGER, EXHAUST MANIFOLD

INDIVIDUAL PARTS