



PARTS MANUAL

AGROTRON L710

TRACTOR - ZKDS8002W0LD10010

PRINTED BY :
heavy-equipmentmanual.com

AGROTRON L710 ->ZKDS8002W0LD10010

A0 - TRACTOR

CONSUMABLE MATERIALS

LUBRICANTS AND SEALANTS.....	A0.03.0 (1)
LUBRICANTS AND SEALANTS.....	A0.03.1 (1)
LUBRICANTS AND SEALANTS.....	A0.03.2 (1)
DIESEL ADDITIVE.....	A0.03.4 (1)

LUBRICANTS AND SEALANTS

Fig.	P/n	QTY	Name
------	-----	-----	------

Notes:
[AGROTRON L710 ->ZKDS8002W0LD10010]

57	01016121	2	adhesive
----	----------	---	----------

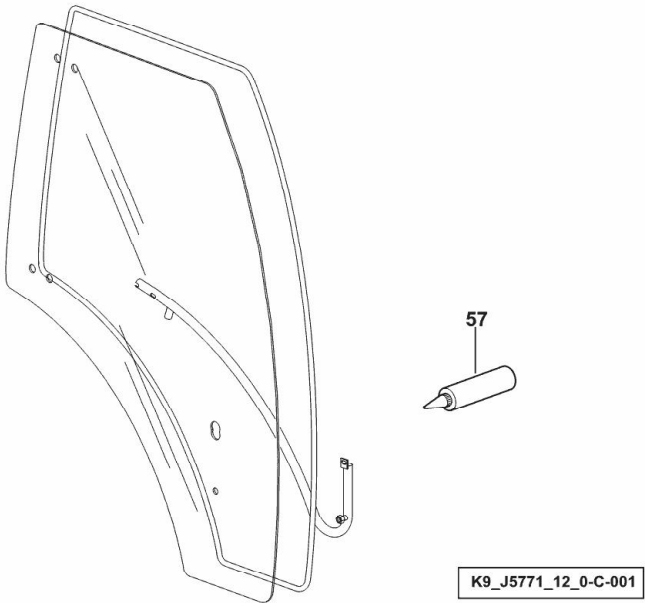

LUBRICANTS AND SEALANTS

Fig.	P/n	QTY	Name
------	-----	-----	------

Notes:
[AGROTRON L710 ->ZKDS8002W0LD10010]

57	01016121	2	adhesive
----	----------	---	----------

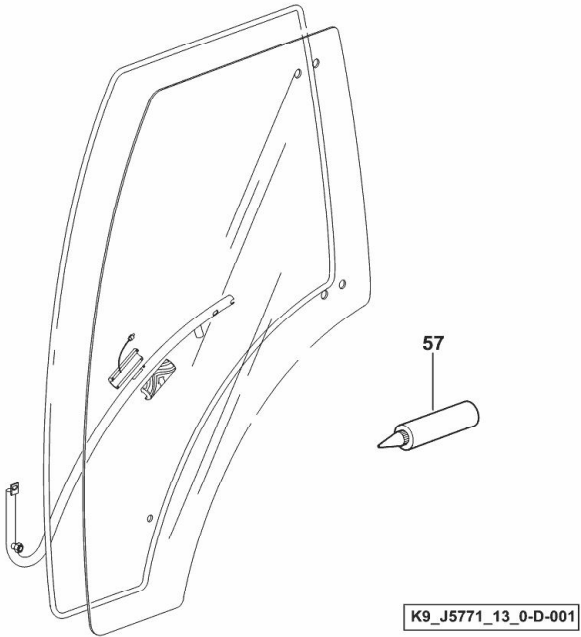

LUBRICANTS AND SEALANTS

Fig.	P/n	QTY	Name
------	-----	-----	------

Notes:
[AGROTRON L710 ->ZKDS8002W0LD10010]

153	01016121	2	adhesive
-----	----------	---	----------

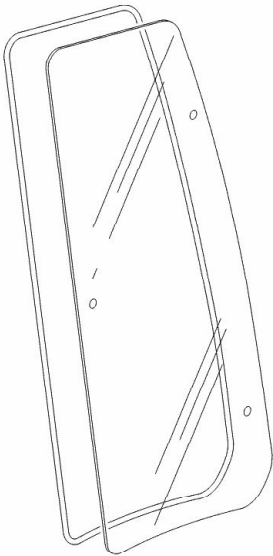

K9_J5771_10_0-D-001

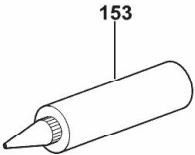

DIESEL ADDITIVE

Fig.	P/n	QTY	Name
------	-----	-----	------

Notes:
- EXPORT RU [AGROTRON L710 ->ZKDS8002W0LD10010]

27	04453435	1	additive
----	----------	---	----------

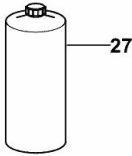

K9_J5919_10_0-A-001

AGROTRON L710 ->ZKDS8002W0LD10010

B0 - ENGINE

GENERAL

ENGINE..... B0.00.0 (1)

CYLINDER BLOCK

FASTENINGS..... B0.01.0

SERIE GUARNIZIONI..... B0.01.2

CRANKCASE BREATHER..... B0.01.4

BLEEDING TUBE..... B0.01.5

CRANKCASE..... B0.01.6

ACCESSORIES..... B0.01.7

OIL FILLER NECK..... B0.01.8

ACCESSORIES..... B0.01.9

FRONT COVER..... B0.01.10

PLUG..... B0.01.11

CLOSING COMPONENTS..... B0.01.13

ACCESSORIES..... B0.01.14

FILLER CAP..... B0.01.16

OIL PRESSUR.SWITCH..... B0.01.17

PISTON COOL.NOZZLE..... B0.01.18

CLOSING COMPONENTS..... B0.01.19

OIL RETURN..... B0.01.20

OIL RETURN..... B0.01.21

CRANKSHAFT

FASTENINGS..... B0.02.0

VIBRATION DAMPER..... B0.02.1

PLUG..... B0.02.2

CRANKSHAFT..... B0.02.4

FLYWHEEL..... B0.02.5

CYLINDERS - PISTONS - CONNECTING RODS

PISTON..... B0.03.0

CONNECTING ROD..... B0.03.2

TIMING

FASTENINGS..... B0.04.0

FASTENINGS..... B0.04.1

FASTENINGS..... B0.04.2

BUSH..... B0.04.3

ROCKER ARM BRACKET..... B0.04.4

ROCKER ARM BRACKET..... B0.04.5

ROCKER ARM BRACKET..... B0.04.6

CAMSHAFT..... B0.04.9

VALVE DRIVE..... B0.04.11

GEARCASE..... B0.04.12

GEARCASE.....	B0.04.13
CYLINDER HEAD	
FASTENINGS.....	B0.05.0
SEALING.....	B0.05.1
ENGINE MOUNTING.....	B0.05.2
CLOSING COMPONENTS.....	B0.05.3
CLOSING COMPONENTS.....	B0.05.4
CYLINDER HEAD.....	B0.05.5
CYLINDER HEAD.....	B0.05.6
VALVE MECHAN.COVER.....	B0.05.7
ROCKER ARMS COVER.....	B0.05.8
LUBRICATION	
ADAPTER.....	B0.06.0
SEALING.....	B0.06.1
BLANKING PARTS.....	B0.06.2
OIL SUCTION PIPE.....	B0.06.3
CLOSING COMPONENTS.....	B0.06.4
OIL PAN.....	B0.06.5
CLOSING COMPONENTS.....	B0.06.6
OIL COOLER BOX.....	B0.06.8
SPIN-ON FILTER.....	B0.06.10
SPIN-ON FILTER.....	B0.06.11
FUEL INJECTION SYSTEM	
FASTENINGS.....	B0.07.0
FASTENINGS.....	B0.07.1
FASTENINGS.....	B0.07.5
HIGH PRESSURE PIPE.....	B0.07.6
FUEL INJECTOR.....	B0.07.7
ADD-ON PARTS ENGINE.....	B0.07.8
FUEL FEED PUMP.....	B0.07.9
FUEL FILTER.....	B0.07.13
FUEL LINE.....	B0.07.14
FUEL LINE.....	B0.07.15
FUEL PUMP.....	B0.07.16
OVERFLOW OIL LINE.....	B0.07.18
ENGINE FUEL PUMP.....	B0.07.19
ROLLER TAPPET.....	B0.07.21
DISTRIBUTOR.....	B0.07.22
MECHANICAL - ELECTRONIC GOVERNOR	
CLOSING COMPONENTS.....	B0.08.0
ELECTRONIC CONTROL UNIT - ENGINE.....	B0.08.2
COOLING	
FASTENINGS.....	B0.09.0
FASTENINGS.....	B0.09.1

FASTENINGS.....	B0.09.2
THERMOSTAT.....	B0.09.4
BELT STRETCHER.....	B0.09.5
COOLING WATER PIPE.....	B0.09.6
HEATER CONNECTION.....	B0.09.7
MANIFOLD.....	B0.09.10
LUEFTERLAGERUNG.....	B0.09.12
BELT STRETCHER.....	B0.09.14
V-BELT.....	B0.09.16
V-GROOVED PULLEY.....	B0.09.17
CONNECTION.....	B0.09.18
INTAKE - EXHAUST MANIFOLDS	
EXHAUST PIPE.....	B0.10.0
SEALING.....	B0.10.2
MANIFOLD.....	B0.10.3
GLOW PLUG.....	B0.10.6
CHARGED AIR MANIFOLD.....	B0.10.7
TURBOCHARGER	
TURBOCHARGER.....	B0.11.0
RETURN LINE.....	B0.11.1
OIL LUBRICATION PIPE.....	B0.11.2
CLOSING COMPONENTS.....	B0.11.4
Electrical accessories	
FASTENINGS.....	B0.12.0
COVER PLATE.....	B0.12.1
FASTENINGS.....	B0.12.2
ACCESSORIES.....	B0.12.3
IMPULSETRANSMITTER.....	B0.12.5
TEMPER.TRANSMITTER.....	B0.12.7
KABELBAUM.....	B0.12.8
ACCESSORIES.....	B0.12.10
DRIVING PARTS.....	B0.12.11
STARTER.....	B0.12.14
ACCESSORIES.....	B0.12.16
GENERATOR.....	B0.12.17
GENERATOR.....	B0.12.20
ACCESSORIES.....	B0.12.21
ACCESSORIES.....	B0.12.22
ACCESSORIES.....	B0.12.23
ACCESSORIES.....	B0.12.25
OIL PRESSUR.SWITCH.....	B0.12.28

ENGINE

Fig.	P/n	QTY	Name
------	-----	-----	------

Notes:
[AGROTRON L710 ->ZKDS8002W0LD10010]

1	25009239	1	engine ON ORDERING PLEASE ENGINE NO. REQUIRED
---	----------	---	---

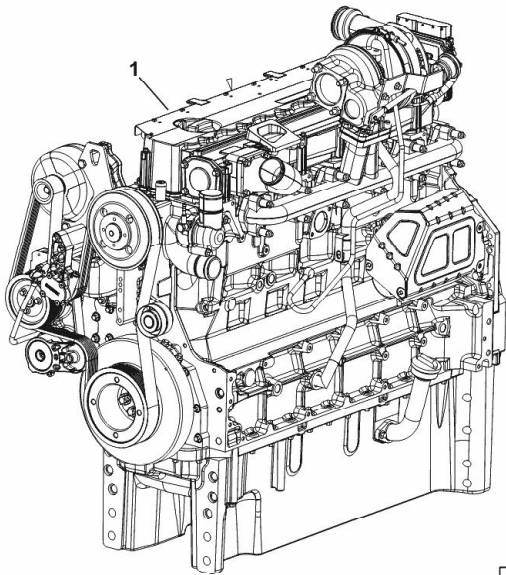

K9_Q5519_01_0-A-001