

SHOP MANUAL

KOMATSU

FB10/14/15/18-4

FB10S/14S/15S/18S-4

MACHINE MODEL

SERIAL NO.

FB10/14/15-4

12001 and up

FB18-4

10151 and up

FB10S/14S/15S-4

11001 and up

FB18S-4

10011 and up

❧ KOMATSU FORKLIFT

FOREWORD

Proper operation, maintenance, troubleshooting and repairs are necessary to preserve the performance of vehicles and engines (engine-powered forklift trucks) over a long period of time and to ensure that faults and breakdowns do not occur.

The object of this Shop Manual is to provide the information necessary especially in connection with the performance of inspections and repairs mainly in the maintenance areas.

For this purpose, it includes sections on "General and Specifications", "Checks and Adjustments", "General Disassembly and Assembly", "Disassembly and Assembly of Components" and the "Electrical System".

Maintenance data necessary for the performance of maintenance on the machines is also included, but reference should be made to the Operation and Maintenance Manual for further details.

Reference should also be made to this manual in connection with correct operation of the machine.

The content of the items mentioned above is as follows.

General and Specifications

This chapter indicates the name of each part of the machine, and the installation positions of the operating devices and instruments.

Checks and Adjustments

This chapter gives the details required for the disassembly and reassembly of machines, such as tightening torque, allowances, as well as the wear limits of the parts. However, when necessary, data in line with the procedure mentioned in the following sections, "General Disassembly and Assembly" and "Disassembly and Assembly of Components" is indicated.

General Disassembly and Assembly

The procedure when disassembling a machine comes within one of the two following categories. In the first, the machine, including the frame, is made up roughly of seven component parts, i.e.: a mast section, a cylinder section, a reach leg, a transfer section, a motor section, a pump section and a frame.

This chapter contains details of how to disassemble and assemble these components. The other category of disassembly and assembly is the disassembly and assembly of component parts referred to in the following chapter.

Disassembly and Assembly of Components

This chapter provides additional explanation concerning those of the seven component parts, as touched upon in the preceding chapter, whose disassembly and assembly procedure is particularly complicated and for which special care is needed when adjusting. Mention is also made of the functions and structures of the component parts.

Electrical System

Explanation is provided in this chapter of the electrical parts used inside the machine. Troubleshooting when a breakdown occurs is also described.

Reference should be made to the "General Shop Manual" for safe operating and working methods which serve as the basis for the performance of repair and inspection works on machines.

01 GENERAL AND SPECIFICATIONS

05 STANDARD TIGHTENING TORQUE

**11 GENERAL DISASSEMBLY AND
ASSEMBLY**

**13 DISASSEMBLY AND ASSEMBLY
OF COMPONENT**

15 ELECTRICAL SYSTEM

21 TROUBLESHOOTING



GENERAL AND SPECIFICATIONS

General view 01-2

Operator’s compartment 01-4

Machine serial number 01-4

Specifications 01-6



GENERAL VIEW



B10P001

1. Mast
2. Lift chain
3. Lift cylinder
4. Back rest
5. Fingerbar
6. Fork
7. Overhead guard
8. Head lamp
9. Turn signal lamp
10. Battery case
11. Counterweight
12. Tilt cylinder
13. Rear wheel
14. Front wheel

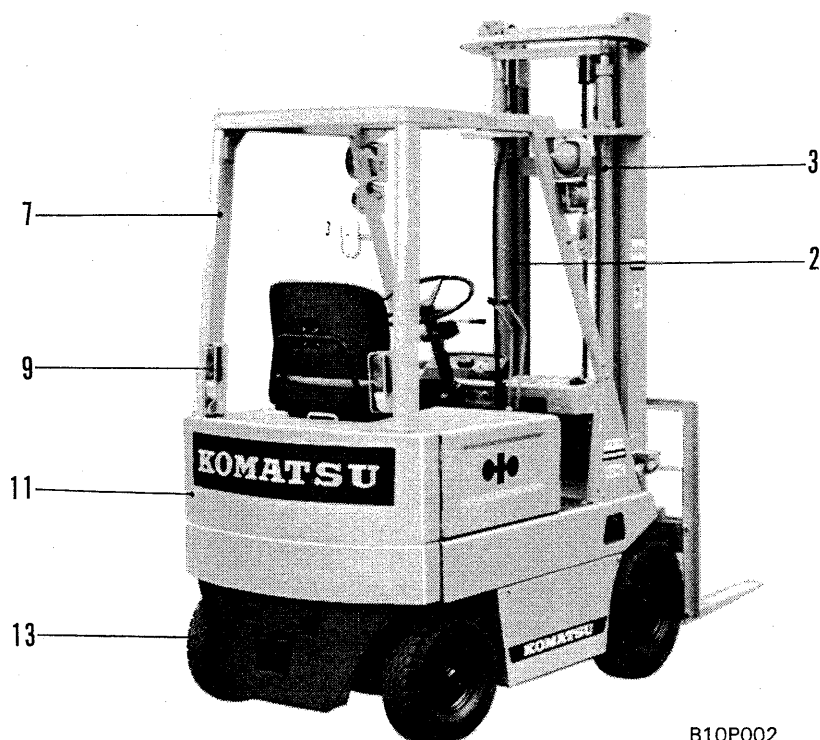

B10P002

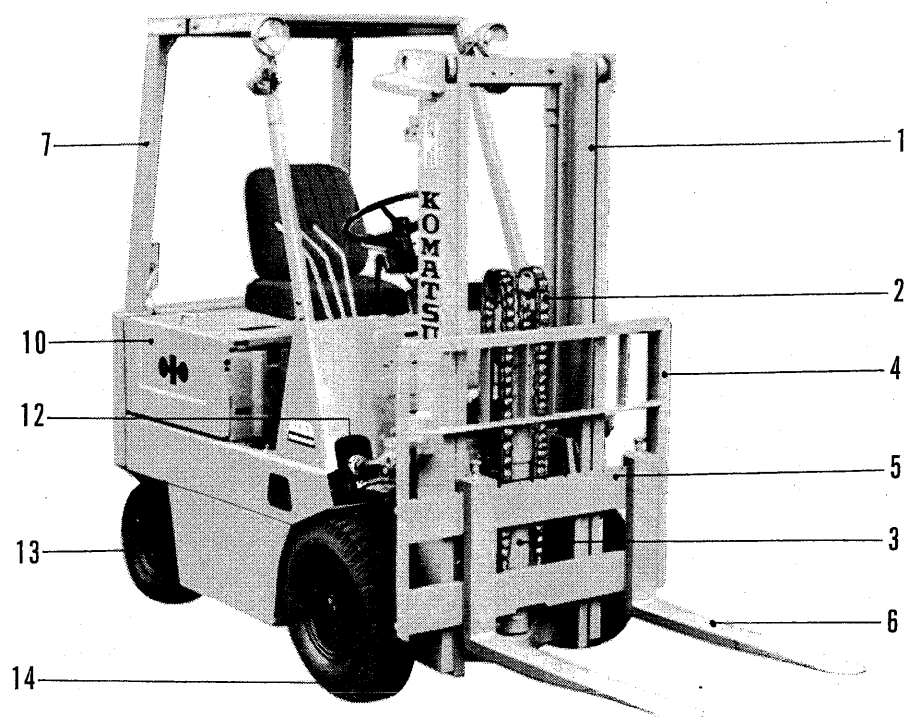

B10P003



B10P004

OPERATOR'S COMPARTMENT

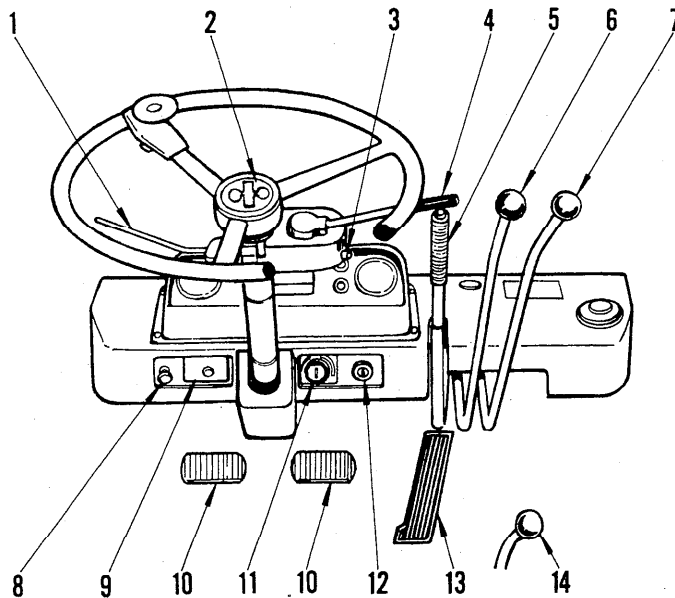

1. Turn signal switch
2. Horn button (option)
3. Power booster
4. Forward-Reverse lever, horn
5. Parking brake lever
6. Lift lever
7. Tilt lever
8. Lamp switch (option)
9. Fuses
10. Brake pedal
11. PCS (Power Control Selector)
12. Starting switch
13. Accelerator pedal
14. Battery plug release lever

MACHINE SERIAL NUMBER

When calling for service or ordering parts, be sure to give your Komatsu distributor the machine model serial number. Machine serial number will be found at left side of dashboard.

