

Section-0 General

Equipment Layout	ES00-03-0056.0R0S
------------------------	-------------------

Section-1 Upper Mechanism

Power Transmission System.....	ES01-01-0057.0R1S
Gears Maintenance Chart	ES01-01-2040.0R0S
Front And Rear Drum Shaft Structure And Outline	ES1-10-0034.0
Front And Rear Drum Shaft Disassembly And Reassembly	ES1-10-6034.0
Third Drum Shaft Structure And Outline	ES1-12-0034.0
Third Drum Shaft Maintenance Chart	ES1-12-2034.0
Third Drum Shaft Disassembly And Reassembly	ES1-12-6034.0
Boom Hoist Drum Outline And Structure	ES01-15-0066.0R0S
Boom Hoist Drum Disassembly And Reassembly	ES01-15-6063.0R0S
Clutch Structure And Outline	ES1-17-0034.0
Clutch Maintenance Chart (2-Cylinder Type)	ES1-17-2034.0
Clutch Troubleshooting (2-Cylinder Type)	ES1-17-4009.0
Clutch Disassembly And Reassembly (2-Cylinder Type)	ES1-17-6034.0
Turntable Bearing Maintenance Chart	ES1-30-2030.0
Power Divider (Pump Splitter) Disassembly And Reassembly	ES01-40-6064.0R0S
Drum Maintenance Chart	ES01-42-2072.0R0S
Drum Indicator Troubleshooting (Mechanical Type)	ES01-50-4001.0R0S

Section-2 Lower Mechanism

Lower General Explanation	ES02-01-0051.0R0S
Tread Drive Sprocket Maintenance Chart	ES02-05-2055.0R0S
Take-Up Idler Maintenance Chart	ES02-07-2059.0R0S
Take-Up Idler Inspection And Oil Replacement	ES02-07-5046.0R0S
Take-Up Idler Disassembly And Reassembly	ES02-07-6053.0R0S
Carrier Roller Maintenance Chart	ES02-08-2054.0R0S
Track Roller Maintenance Chart	ES02-09-2048.0R0S
Track Shoe Maintenance Chart	ES02-10-2053.0R0S
Track Shoe Inspection And Adjustment	ES02-10-5052.0R0S
Track Shoe Disassembly And Reassembly	ES02-10-6052.0R0S
Tread Member Maintenance Chart	ES02-12-2048.0R0S
Travel Reduction Gear Case Oil Inspection And Replacement	ES02-21-5050.0R0S

Section-3 Control System

Front And Rear Drum Brakes Control Maintenance Chart	ES3-5-2034.0
Front And Rear Drum Brakes Control Inspection And Adjustment	ES3-5-5034.0
Front And Rear Drum Brakes Control Disassembly And Reassembly	ES3-5-6034.0

Section-4 Hydraulic System

Hydraulic Circuit Outline	ES04-01-0070.0R1S
Hydraulic Circuit Pressure Adjustment	ES04-01-5074.0R0S

Section-5 Hydraulic Unit

Variable Delivery Pump Outline And Structure	ES05-02-0054.0R0S
Gear Pump Troubleshooting (Single Type)	ES5-3-4023.0
Gear Pump Troubleshooting (3-Series Type)	ES5-3-4050.0
Gear Pump Disassembly And Reassembly (3-Series Type)	ES05-03-6049.0R0S
Gear Pump Disassembly And Reassembly (Single Type)	ES05-03-6050.0R0S
Accumulator Structure And Working	ES05-05-0034.0R1S
Accumulator Inspection And Adjustment	ES05-05-5031.0R1S
Accumulator Disassembly And Reassembly	ES05-05-6045.0R0S
Rotating Joint Disassembly And Reassembly	ES05-14-6029.2R1S
Brake Booster Structure And Working	ES05-16-0016.0R1S
Brake Booster Disassembly And Reassembly	ES05-16-6005.0R1S
Remote Control Valve Structure And Operation	ES05-17-0029.0R1S
Remote Control Valve Troubleshooting	ES05-17-4027.0R0S
Remote Control Valve Disassembly And Reassembly	ES05-17-6027.0R0S
Clutch Cylinder Disassembly And Reassembly (2-Cylinder Type, R.H.)	ES5-18-6034.0
Automatic Brake Cylinder Disassembly And Reassembly	ES5-19-6032.0
Line Filter Inspection	ES5-30-5061.0
Line Filter Disassembly And Reassembly	ES5-30-6061.0
Return Filter Inspection	ES5-32-5011.0
Return Filter Disassembly And Reassembly	ES5-32-6011.0
8-Way Rotating Joint Inspection	ES05-34-5013.0R0S
8-Way Rotating Joint Disassembly And Reassembly	ES05-34-6013.0R0S
Swing Control Valve Structure And Operation	ES05-35-0054.0R1S
3-Series Control Valve Structure And Operation	ES05-37-0051.0R0S
4-Series Control Valve Structure And Operation	ES05-38-0041.0R0S
6-Series Control Valve (Jack-Up And Side Frame Retract)	ES05-40-0004.0R0S
Counterbalance Valve Outline And Operation	ES05-46-0001.0R0S
Check Blocck Structure And Outline	ES05-49-0013.0R0S
Take-Up Cylinder Disassembly And Reassembly	ES05-57-6048.0R0S

Section-7 Crane Attachment

Live Mast And Boom Foot Maintenance Chart	ES7-8-2034.0
---	--------------

Section-13 Electrical System

Electrical Diagram ----- ES13-01-0026.0R0S

Electrical System Standardization ----- ES13-01-9033.0R0S

Storage Battery Servicing And Installation ----- ES13-04-5004.0R0S

Section-14 Tightening Torque Table

Bolt Tightening Torques ----- ES14-02-0004.0R0S

1 Crane Main Body External View And Names

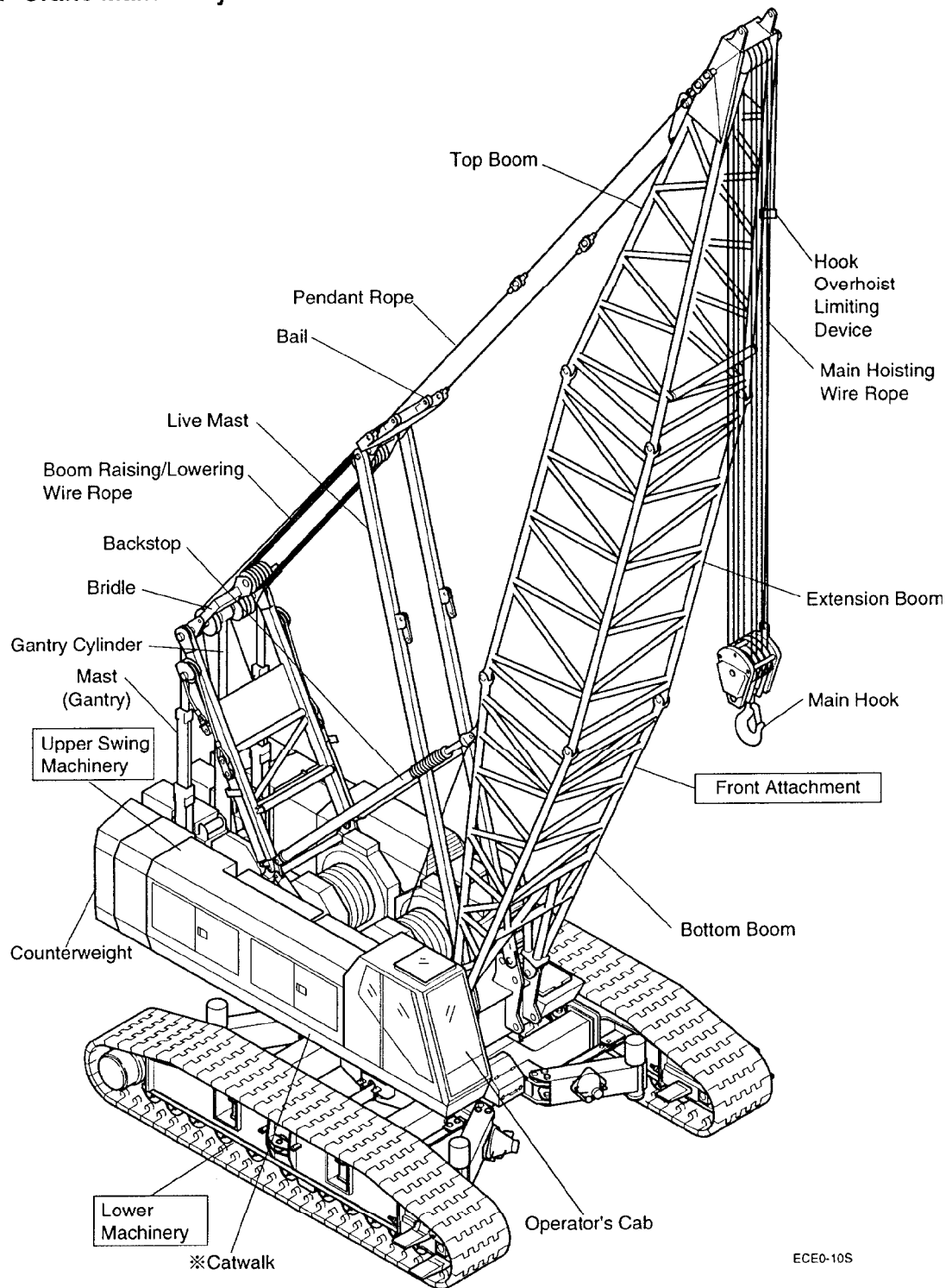

※ : Indicates options.

- For hydraulic equipment layout, refer to ES05-01-00 ○○ in this manual.
- For electric equipment layout, refer to ES13-01-00 ○○ in this manual.

2 Upper Machinery

2.1 Operating Equipment Inside Operator's Cab

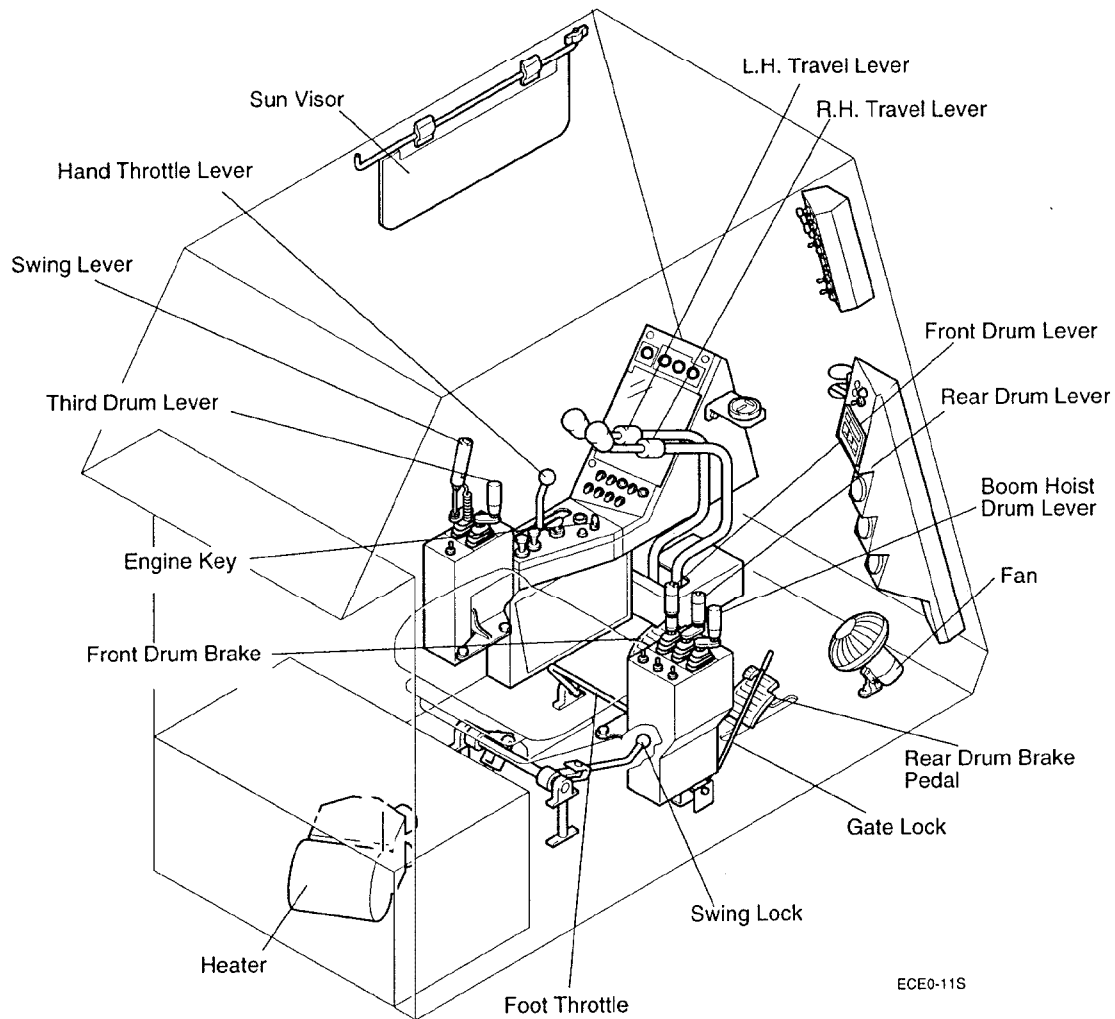

2.2 General Equipment Of Upper Machinery

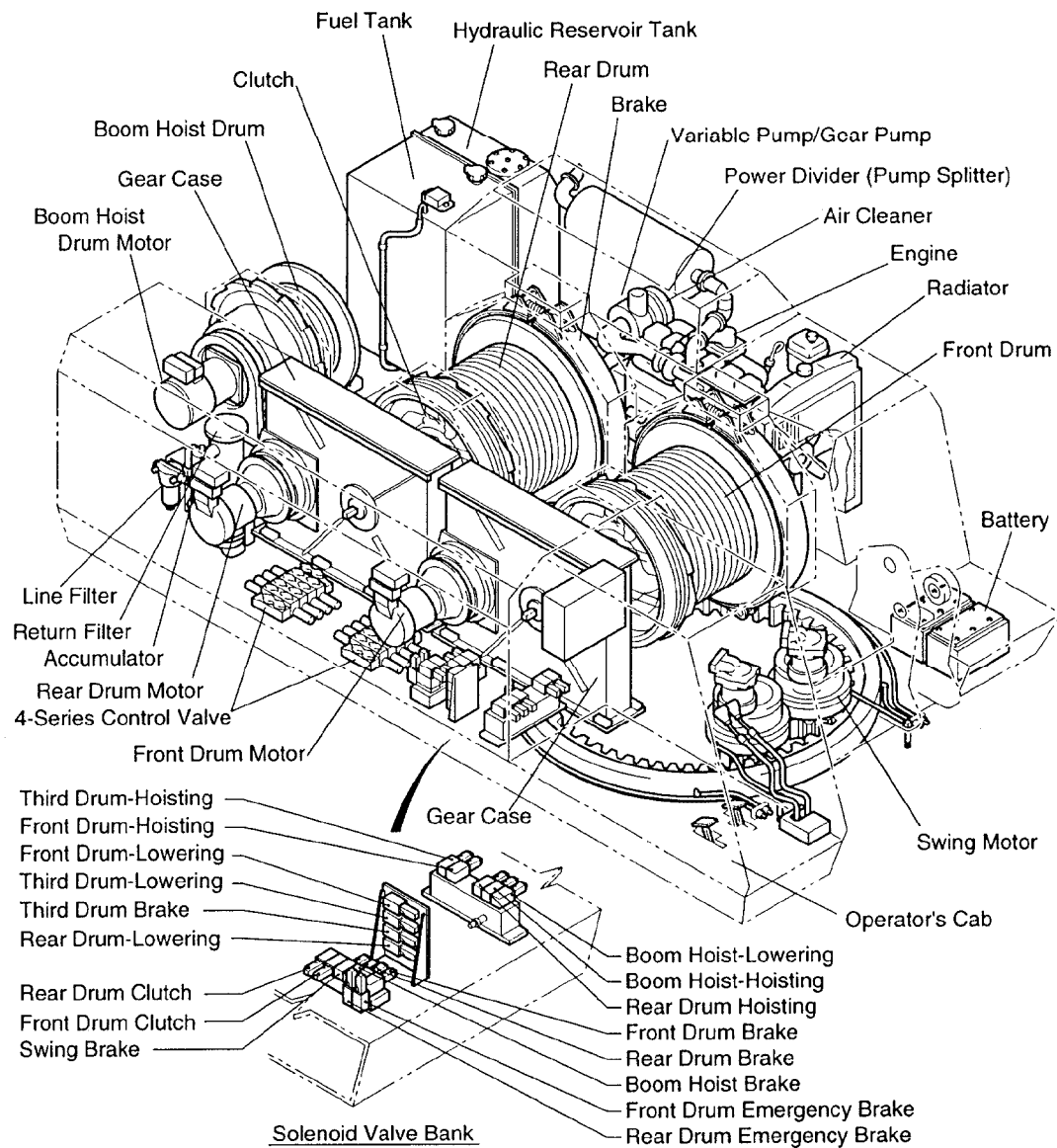

ECE0-12S

3 Lower Travel Machinery

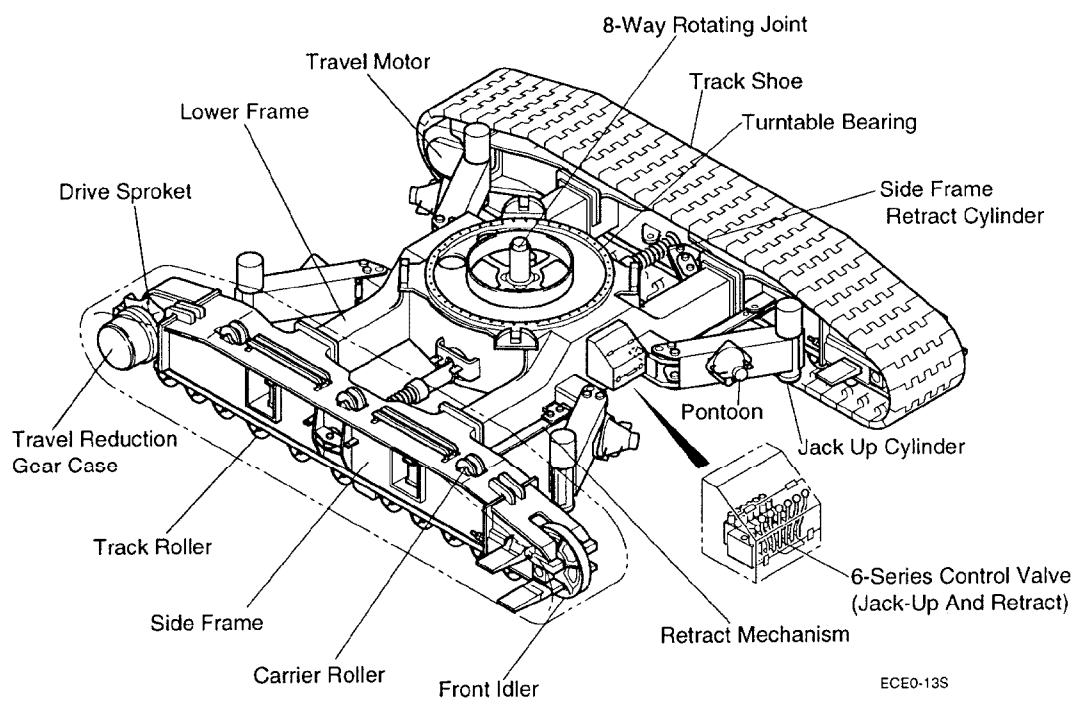

Power from the engine is separated by the power divider (pump splitter) to drive hydraulic pumps. The rotating energy of engine power is also converted into fluid energy (the flow of high pressure hydraulic oil) which is directed by the control valves, through hydraulic lines, to various actuators.

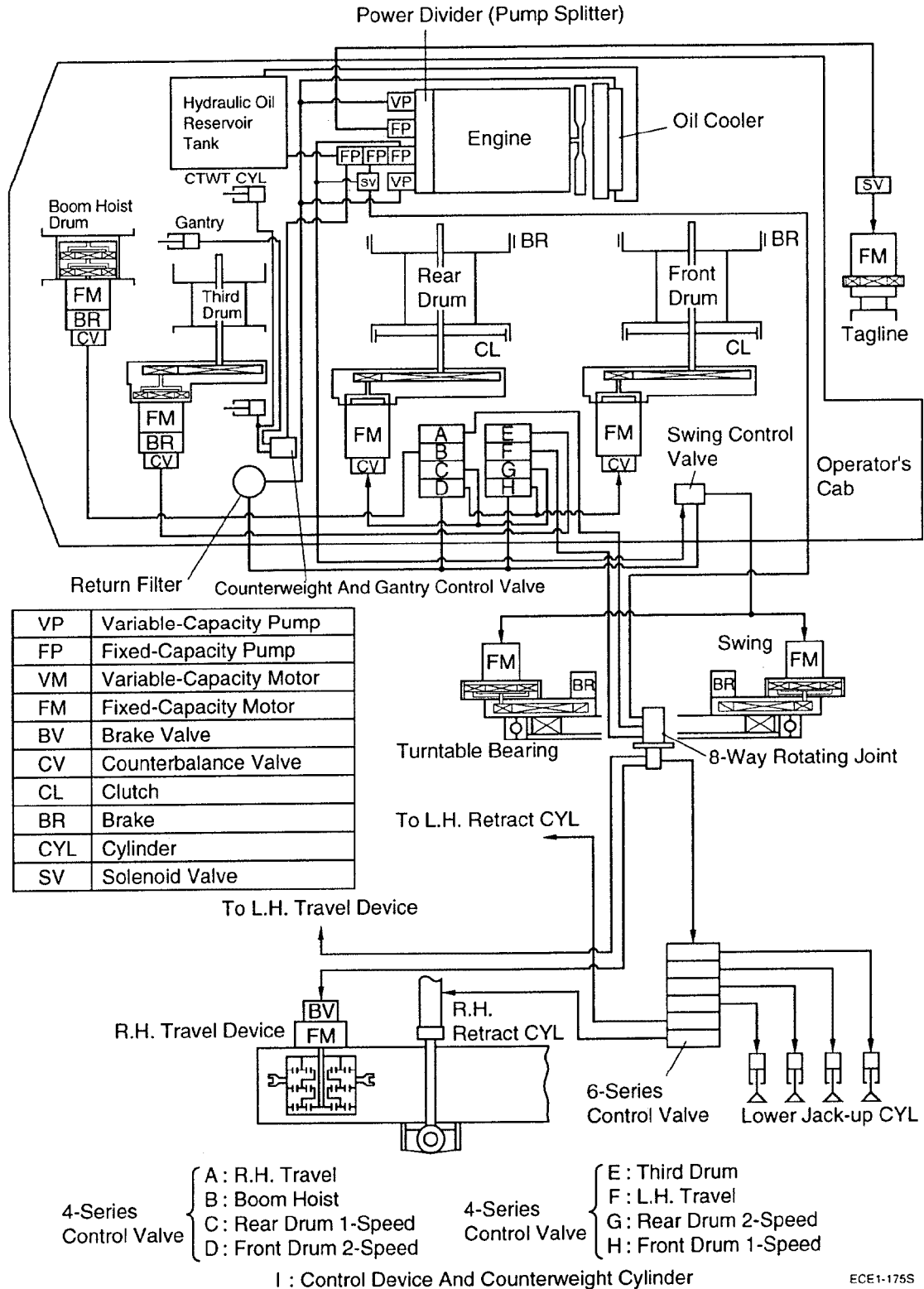

ECE1-175S

