

# Massey Ferguson®

9792 / 9776

Planter

## SERVICE MANUAL

4283531M1

## CONTENTS

GENERAL INFORMATION .....	01
ROW UNIT .....	02
DRIVE SYSTEMS .....	03
AIR SYSTEM .....	04
HYDRAULICS .....	05
ELECTRICAL .....	06
FRAME .....	07
TROUBLESHOOTING .....	08
CONSOLES AND MONITORS .....	09

---

**Massey Ferguson®****9792 / 9776****Planter****SERVICE MANUAL****4283531M1****01 - General Information****Contents**

<b>GENERAL INFORMATION</b>	
General Information .....	01-1
Serial Number .....	01-2
Serial Number Description (2010 and up) .....	01-2
<b>SAFETY</b>	
Safety Alert Symbol .....	01-3
Safety Messages .....	01-3
Informational Messages .....	01-4
Safety Signs .....	01-4
General Operation and Service .....	01-5
Operating .....	01-5
Agricultural Chemicals .....	01-6
Transporting .....	01-6
Servicing .....	01-7
<b>SPECIFICATIONS</b>	
Stack Fold .....	01-9
General Information .....	01-9
9792-36 .....	01-9
9792-38 .....	01-9
9792-40 .....	01-9
9776 .....	01-10
Air System .....	01-10
Pneumatic Down Pressure .....	01-10
Hydraulic System .....	01-11
Approximate Shipping Weight .....	01-12
Monitor .....	01-12
Electronic Seed Drive Controller .....	01-12
Tractor Requirements .....	01-13
Maximum Speed .....	01-13
INDEX .....	01-15



# GENERAL INFORMATION

## GENERAL INFORMATION



FIG. 1

**FIG. 1:** Mounted Stack Fold 12 Row Planter

The stacking toolbar frame design of the 9700 Series Mounted Stack Fold Planters provides narrow transport widths and allows folding for transport without emptying the hoppers. The planters also include low profile, rear fold markers. The models feature the 8000 Series air seed metering system for accurate seed singulation and placement, and are designed for use in conventional, mulch till or ridge till conditions.

Two basic models are available:

Model 9792, 12 row wide (36, 38, or 40 inch)

Model 9776, 16 row narrow (30 inch)



**WARNING:** Pictures in this manual may show protective shields and guards opened or removed for illustration purposes. Be sure all shields and guards are in place during operation.

This manual was prepared from the latest product information available at publication time. The Company reserves the right to make changes at any time without notice or obligation.

## General Information

### SERIAL NUMBER

**FIG. 2:** The serial number plate (1) is found on the rear of the frame near the blower.

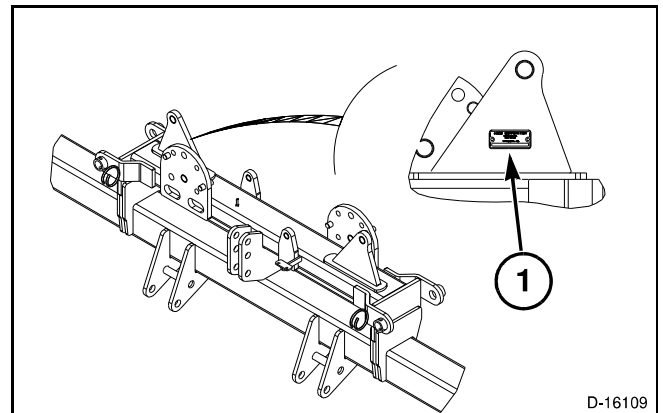

**FIG. 2**

### SERIAL NUMBER DESCRIPTION (2010 AND UP)

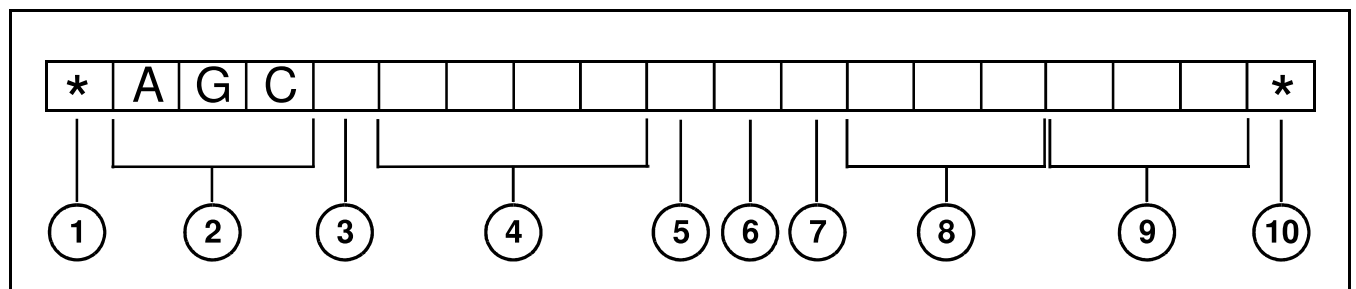

**FIG. 3**

**FIG. 3:** Description of the serial number for model year 2010 and up.

- (1) Beginning symbol
- (2) World Manufacturer Code
- (3) Brand Code
- (4) Model Identifier (Model number)
- (5) Check Letter (0 or used if model identifier is five digits)
- (6) Model Year Code (A=2010, B=2011, C=2012, and on)
- (7) Plant Code
- (8) Family Code
- (9) Unit Number for the Year
- (10) Ending symbol

**NOTE:** For serial number breaks in this manual, only the information from the model year code and following will be given.

# SAFETY

## SAFETY ALERT SYMBOL

**FIG. 4:** The safety alert symbol means ATTENTION! BECOME ALERT! YOUR SAFETY IS INVOLVED!

Look for the safety alert symbol both in this manual and on safety signs on this machine. The safety alert symbol will direct your attention to information that involves your safety and the safety of others.

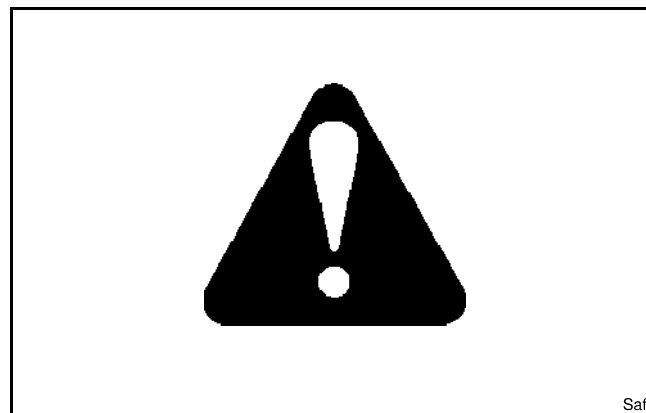

FIG. 4

## SAFETY MESSAGES

**FIG. 5:** The words DANGER, WARNING or CAUTION are used with the safety alert symbol. Learn to recognize these safety alerts and follow the recommended precautions and safety practices.



**DANGER:** Indicates an imminently hazardous situation that, if not avoided, will result in DEATH OR VERY SERIOUS INJURY.



**WARNING:** Indicates a potentially hazardous situation that, if not avoided, could result in DEATH OR SERIOUS INJURY.



**CAUTION:** Indicates a potentially hazardous situation that, if not avoided, may result in MINOR INJURY.



FIG. 5

# Safety

---

## INFORMATIONAL MESSAGES

The words IMPORTANT and NOTE are not related to personal safety, but are used to give additional information and tips for operating or servicing this equipment.

*IMPORTANT: Identifies special instructions or procedures which, if not strictly observed, can result in damage to or destruction of the machine, process, or its surroundings.*

*NOTE: Identifies points of particular interest for more efficient and convenient repair or operation.*

## SAFETY SIGNS



**WARNING: DO NOT remove or obscure safety signs. Replace any safety signs that are not readable or are missing. Replacement signs are available from your dealer in the event of loss or damage. The actual location of the safety signs is illustrated at the end of this section.**

If a used machine has been purchased, make sure all safety signs are in the correct location and can be read.

Replace any safety signs that can not be read or are missing. Replacement safety signs are available from your dealer.

---

## **GENERAL OPERATION AND SERVICE**

### **Operating**

- Read and understand all the operating and safety precautions before operating machinery.
- In addition to equipment configuration and design, hazard control and accident prevention depend on awareness, concern, prudence and proper training of personnel in the operation, maintenance, transport and storage of equipment.
- Always raise implement, shut off tractor engine, set the parking brake, shift to park position (or neutral) remove the key and install cylinder lockup channels before working around the machine.
- Avoid working under the planter. However, if it becomes unavoidable to do so, make sure planter is securely blocked and cylinder lockup channels are in place.
- Do not attempt to lubricate or adjust planter while the machine is in operation.
- Machinery operation must be performed only by persons who are responsible and delegated to do so.
- Only the operator must be permitted on the tractor (unless tractor has a factory-installed instructor seat) when tractor and planter are moving. Never permit anyone to ride on the planter.
- Avoid wearing loose-fitting clothing and jewelry. Always tie up long hair that can be caught in moving parts.
- Wear personal protective equipment (PPE) such as, but not limited to, protection for the eyes, lungs, ears, head, hands and feet when operating, servicing or repairing equipment.
- Make sure bystanders are clear before operating tractor or machine.
- Do not leave the tractor or implement unattended with the engine running.
- Never attempt to operate the planter unless seated in the operator's seat on the tractor.
- Tractor must be equipped with a rollover protective structure (ROPS), and a seat belt. Use seat belt during operation.
- Make sure the tractor is in good operating condition, and has adequate braking capabilities.
- Do not dismount from the moving tractor.
- Regulate ground speed to field conditions, and maintain control at all times.
- Watch for overhead wires or other obstructions when raising markers, and when moving planter with marker(s) raised.
- Disconnect and store the planter where children do not normally play. Stabilize the planter by using suitable supports, and block the wheels.
- Always lower planter when not in use and relieve pressure in the hoses and cylinders.
- Do not allow children to ride on, play on, or operate equipment. Always keep children away from equipment operating, servicing, and storage areas.
- Do not stand between tractor and planter to install hitch pin when tractor engine is running.



# Safety

---

## Agricultural Chemicals

- Ag chemicals can be very hazardous. Improper use of fertilizer, fungicides, herbicides, insecticides and pesticides can injure people, plants, animals, soil and other people's property.
- Always read and follow all manufacturers' instructions before opening any chemical container.
- Even if you think you know them, read and follow instructions each time you use a chemical.
- Use same precautions when adjusting, servicing, cleaning or storing planter as used when installing chemicals into hoppers or tanks.
- Inform anyone who comes in contact with chemicals of the potential hazards involved and the safety precautions required.
- Stand upwind and away from smoke from a chemical fire.
- Store or dispose of all unused chemicals only in a manner as specified by the chemical manufacturer.

## Transporting

- Use tractor of recommended size and weight to tow the machine.
- Use good judgment when transporting planter on the highway. Maintain complete control of machine at all times.
- Comply with state and local laws governing highway safety and regulations when moving machinery.
- Always make the necessary safety precautions prior to transporting machine on public roads.
- Make sure the SMV (Slow Moving Vehicle) emblem is clean and visible.
- Use flashing warning lights except when prohibited by law.
- Watch for overhead wires or other obstructions when transporting the planter with markers raised.
- Always fasten the transport safety chain to the tractor drawbar and use the retainer on the hitch pin.
- Always install the marker lockup pins before transporting or parking the planter.
- Always install the wheel cylinder lockup channels before transporting or parking the planter.
- Vertical Fold Models: Always install wing lockup pins before transporting or parking planter.
- Do not transport planter in excess of 25 kph (15 mph).

### Servicing

- After repairing or adjusting the planter, remove all tools and parts from the machine before operating.
- When working around discs, be careful to not get cut on sharp edges.
- Lower the planter to the ground before attempting to remove a wheel for tire repair.
- Tire changing can be very hazardous and must be done by trained personnel using proper tools and equipment.
- Do not re-inflate a tire that was seriously under-inflated or run flat. Have it checked by qualified personnel.

**FIG. 6:** Fluid Leak Detection

Correct hydraulic leaks immediately. All fittings must be tight and all lines and hoses in good condition. Escaping hydraulic fluid, under extremely high pressure, can penetrate the skin and cause blood poisoning. Use a piece of wood or cardboard to detect fluid leaks. If injured by escaping fluid, see a doctor immediately.

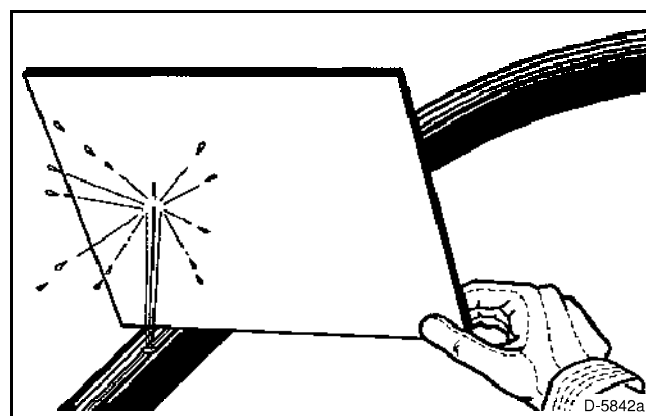

**FIG. 6**