

GC2300 / GC2310 TRACTOR REPAIR TIME SCHEDULE

Form Number 4283091M1

Contents

| Section | Description |
|---------|----------------------|
| 1 | Engine Components |
| 2 | Chassis |
| 3 | Wheels |
| 4 | Component Breakdowns |

*NOTE: This Repair Time Schedule (RTS) can be used with Repair Time
Schedule storage binder supplied separately through the repair parts department.*

A. TIME ALLOWANCE

The times listed in this publication are the result of careful study of the operation concerned; they represent the average time ONE trained Dealer mechanic, of normal ability has taken to carry out the operation in a typical Dealership, using standard workshop tooling and equipment including air tools, located for reasonable access and working conditions. They DO NOT include any traveling to or from the farm or site.

The machine is assumed to be clean and to be bare of any extra equipment or attachment of non "AGCO" manufacture, and delivered to an authorized and duly equipped workshop where trained personnel and spare parts required to perform the operations are immediately available.

The times given include difficulties encountered working on used as opposed to new machines, and are based on methods and recommended tools shown in the workshop manual.

The times are based on a second hand machine in reasonable condition properly maintained using approved parts. Extra time may be required to deal with seized, rusted or damaged parts.

Allowances are included in the operation times quoted for obtaining all tools and parts, cleaning and testing after repair. Diagnostic time is included in the time allowance unless a separate code is listed for diagnostic time.

The times given in this Repair Time Schedule are for a complete job from start to finish, including allowances for intermediate operations.

B. TIMES

All the operating times are presented in hours and the decimal parts of an hour. Decimal times must be used on all warranty claims.

The times given in this repair time schedule are for a complete job from start to finish. Where access has been gained for an adjacent repair only the additional time for the second repair will be accepted and not the total time for the two failures.

C. REVIEW OF TIMES

If you find any improvement in the method which reduces the time of an operation or you find you cannot meet an operation time after more than three attempts using the recommended method, a "Request for Review of Time" form (see next page) must be submitted quoting all relevant details. Photo copy the form and fax it to the following address:

AGCO Corporation
Attn: Product Reliability
FAX (620) 327-5713

D. AMENDMENTS

All times contained in this schedule are based on the latest information available at the time of this publication. The right is reserved to publish revision at any time. All operation times are subject to amendment if the design, method or technique changes result in alteration of time taken.

E. REQUEST FOR REVIEW OF TIME SCHEDULE

Request for Review of Time Schedule

Dealer Name: _____ Date: _____

Address: _____

RTS Publication No.: _____ Failure Code No.: _____

Machine Model: _____ Serial No.: _____

We wish to query your time allowance against the above failure code number and confirm that we have observed and accurately timed this operation as carried out by a trained mechanic using recommended procedures and special tools, our findings are detained below:

| Analysis of Time | | | |
|----------------------------------|-------------|--|----------------|
| Work Performed | Time | | Remarks |
| Remove Component | | | |
| Dismantle | | | |
| Clean and Inspect | | | |
| Obtain Parts and tools | | | |
| Reassemble | | | |
| Reinstall | | | |
| Adjust and test | | | |
| | | | |
| TOTAL OF TIME | | | |
| Number of mechanics used on job. | | | |

Printed Name: _____ Signed: _____

Fax To:
 AGCO Corporation
 Attn: Product Reliability
 (620) 327-5713

CHASSIS

| | |
|--|----|
| ACCELERATOR LEVER SYSTEM | 33 |
| AIR CLEANER SYSTEM | 29 |
| AXLE BRACKET SYSTEM | 61 |
| AXLE HOUSING SYSTEM | 64 |
| AXLE HOUSING, WHEEL SHAFT SYSTEM | 53 |
| BATTERY SYSTEM | 32 |
| BEVEL CASE SYSTEM | 63 |
| BRAKE PEDAL SYSTEM | 55 |
| BRAKE SYSTEM | 54 |
| CHANGE (4WD) SYSTEM | 44 |
| CHANGE (PTO) SYSTEM | 45 |
| CHANGE (SUB) SYSTEM | 43 |
| CONTROL SYSTEM | 68 |
| COOLING SYSTEM | 27 |
| COVER SYSTEM | 76 |
| CYLINDER CASE SYSTEM | 67 |
| CYLINDER SYSTEM | 59 |
| DIFF-LOCK SYSTEM | 52 |
| DIFF-LOCK PEDAL SYSTEM | 56 |
| DIFFERENTIAL GEAR SYSTEM | 51 |
| DRIVE SHAFT SYSTEM | 62 |
| ENGINE MOUNT SYSTEM | 26 |
| EXHAUST SYSTEM | 28 |
| FENDER SYSTEM | 77 |
| FLOOR SYSTEM | 79 |
| FUEL PUMP SYSTEM | 30 |
| FUEL TANK SYSTEM | 31 |
| GEAR (4WD) SYSTEM | 40 |
| GEAR (PTO) SYSTEM | 41 |
| GEAR CASE, FRONT SYSTEM | 65 |
| GRILLE, HEAD LAMP SYSTEM | 75 |
| HARNESS SYSTEM | 83 |
| HOOD SYSTEM | 74 |
| HST SYSTEM | 37 |
| INPUT SHAFT SYSTEM | 34 |
| INSTRUMENT PANEL SYSTEM | 81 |
| LABELS (CAUTION) | 88 |
| LABELS (CONTROL) | 87 |
| LEVEL (SUB,4WD) SYSTEM | 46 |
| LEVER (PTO) SYSTEM | 47 |
| LIFT ROD SYSTEM | 72 |
| LINK SYSTEM (3PT) | 71 |
| MAIN PIPING SYSTEM | 69 |
| METAL (HST) SYSTEM | 36 |
| METAL (PTO) SYSTEM | 42 |
| MOWER LINK SYSTEM | 73 |
| ORNAMENTATION GC2300, GC2310 | 86 |
| PARKING BRAKE SYSTEM | 57 |
| PEDAL (HST) SYSTEM (A TYPE) 2 OF 2 | 49 |
| PEDAL (HST) SYSTEM (EXCEPT A TYPE) | 48 |
| PINION (DRIVE) SYSTEM | 50 |
| POWER STEERING PIPING SYSTEM | 60 |
| POWER STEERING SYSTEM | 58 |
| PUMP GEAR SYSTEM | 38 |
| ROPS SYSTEM | 84 |
| ROPS SYSTEM (TLB TYPE ONLY) | 85 |
| SEAT SYSTEM | 78 |
| SMV BRACKET | 89 |
| SUB GEAR SYSTEM | 39 |
| SUB PIPING SYSTEM | 70 |
| SWITCH SYSTEM | 82 |
| TAIL LAMP SYSTEM | 80 |
| TIE ROD SYSTEM | 66 |
| TRANSMISSION CASE SYSTEM | 35 |

COMPONENT BREAKDOWNS

| | |
|---|----|
| ALTERNATOR COMPONENTS | 95 |
| CONTROL VALVE ASSY COMPONENTS | 91 |
| FUEL FILTER ASSY COMPONENTS | 93 |
| HYDROSTATIC TRANSMISSION COMPONENTS | 92 |
| PTO CLUTCH ASSY COMPONENTS | 94 |

ENGINE COMPONENTS

| | |
|---|----|
| ADAPTER | 23 |
| CAMSHAFT | 14 |
| COOLING FAN | 19 |
| CRANKSHAFT | 16 |
| CYLINDER BLOCK | 9 |
| CYLINDER HEAD | 5 |
| CYLINDER HEAD COVER | 6 |
| ELECTRIC (1) STARTER AND ALTERNATOR | 24 |
| ELECTRIC (2) SWITCHES, SOLENOID & RELAY | 25 |
| EXHAUST MANIFOLD | 8 |
| FUEL PIPE | 22 |
| INJECTION NOZZLE | 20 |
| INJECTION PUMP | 21 |
| INTAKE MANIFOLD | 7 |
| OIL PAN | 10 |
| OIL PUMP | 17 |
| PISTON STANDARD | 15 |
| REAR PLATE | 11 |
| TIMING GEAR CASE | 12 |
| VALVE TRAIN | 13 |
| WATER PUMP AND THERMOSTAT | 18 |

WHEELS

| | |
|--------------------------|----|
| FRONT & REAR WHEEL | 90 |
|--------------------------|----|

GC2300 / GC2310 TRACTOR
ENGINE COMPONENTS

CYLINDER HEAD

Item

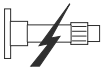

Description

5

| | | | |
|---|----------|-----|------------------------------|
| 1 | 52 03 00 | 2.5 | HEAD ASSY, CYLINDER |
| 2 | 52 02 00 | 1.0 | CUP, SEALING |
| 4 | 52 18 00 | 1.6 | SEAL, VALVE SET |
| 6 | 52 04 00 | 4.5 | GASKET, HEAD |
| 7 | 51 14 00 | 1.3 | BOLTS, CYLINDER HEAD |
| | 52 03 01 | 4.5 | HEAD ASSY, CYLINDER OVERHAUL |

MFC8613

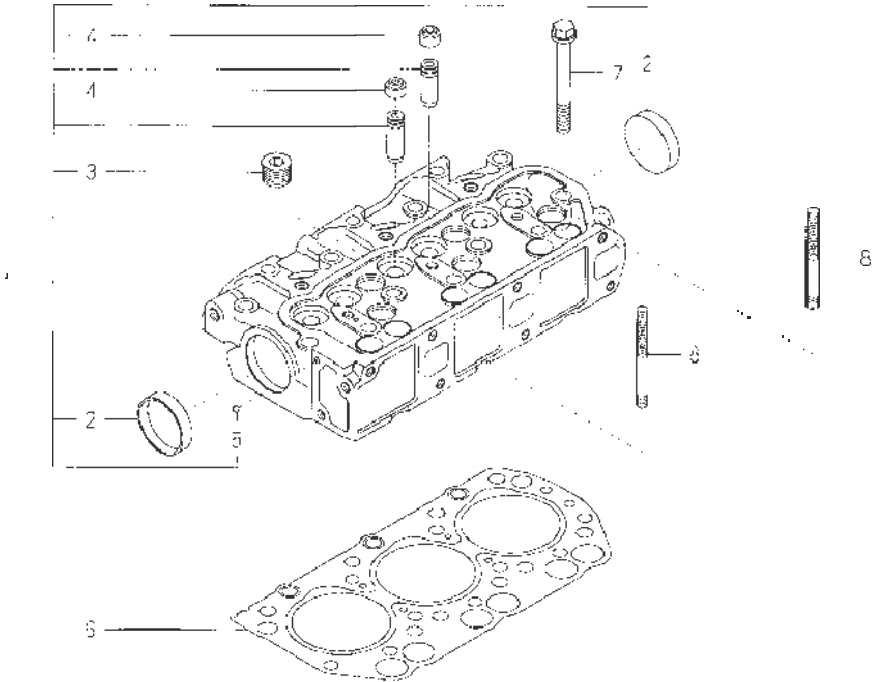

MFC8613