

Page Title	Page Number
CYLINDER BLOCK, CYLINDER HEAD AND END PLATES	6
CRANKSHAFT, MAIN BEARINGS AND CAPS,	8
CRANKSHAFT, MAIN BEARINGS AND CAPS,	10
PISTONS, RINGS, PINS AND CONNECTING RODS (22K, 22)	12
ENGINE GASKETS AND SEALS (22K, 22)	16
VALVES, CAMSHAFT, TIMING GEAR AND COVER (22K, 22)	18
VALVES, CAMSHAFT, TIMING GEAR AND COVER (22K, 22)	20
OIL PUMP AND PRESSURE RELIEF VALVE, OIL PAN (GAS) (22K, 22)	22
OIL PUMP AND PRESSURE RELIEF VALVE, OIL PAN (LOW GRADE)	24
OIL PUMPS (GAS) USED ENGINE SERIAL NUMBERS 18317 THRU 29132	26
OIL PUMPS (GAS) USED PRIOR TO ENGINE SERIAL NUMBER 18317	28
OIL FILTER, OIL LINES AND PRESSURE GAUGE (22K, 22)	30
WATER PUMP, FAN AND STARTING CRANK (22K, 22)	32
RADIATOR AND ATTACHING PARTS (22K, 22)	34
MANIFOLD, MUFFLER, AIR CLEANER AND CARBURETER (22K, 22)	36
FUEL TANKS AND SUPPORTS, FUEL STRAINER AND LINES (22K, 22)	38
CARBURETER (22K, 22)	40
GOVERNOR, THROTTLE CONTROL AND CHOKE (22K, 22)	42
INSTRUMENT PANEL AND INSTRUMENTS, IGNITION, CABLES AND WIRES	44
DISTRIBUTOR (22K, 22)	46
LIGHTING EQUIPMENT (22K, 22)	48
GENERATOR	50
GENERATOR	52
STARTER (22K, 22)	54
FRONT AXLE AND SUPPORTS, SPINDLES AND TIE ROD (STANDARD)	56
FRONT AXLES AND SUPPORTS (ROW CROP) (22K, 22)	58
FRONT AXLES AND SUPPORT, SPINDLE AND TIE ROD	60
FRONT AXLES AND SUPPORT, SPINDLE AND TIE ROD	62
FRONT AXLES AND SUPPORT, SPINDLE AND TIE ROD	64
STEERING GEAR (STANDARD) 22K, 22	66
STEERING GEAR (ROW CROP) 22K, 22	68
STEERING GEAR (ADJUSTABLE HI-ARCH) 22K, 22	70
STEERING GEAR (SINGLE FRONT WHEEL) 22K, 22	72
TRANSMISSION CASE AND FRAME (22K, 22)	74
CLUTCH, CLUTCH SHAFT AND UNIVERSAL JOINTS (22K, 22)	76
CLUTCH HOUSING AND CONTROL (22K, 22)	78
TRANSMISSION (22K, 22)	80
FINAL DRIVE GEARS AND DIFERENTIAL (22K, 22)	82
TRANSMISSION COVER AND CONTROLS BELT PULLEY (22K, 22)	84
REAR AXLES AND SLEEVES, DRAWBAR (22K, 22)	86
BRAKES (22K, 22)	88
WHEELS (CURRENT)	90
WHEELS, REAR (NON-CURRENT)	92
PLATFORMS AND FENDERS, DECALS (HOOD AND DOORS,	94
SEAT (22K, 22)	96
POWER TAKE-OFF, TOOL BOX AND TOOLS (22K, 22)	98
THREE POINT HITCH (LIFT SHAFT) (USED LATE MACHINES)	100
THREE POINT HITCH (USED EARLY MACHINES) 22K, 22	102
HYDRAULIC CYLINDER, VALVE AND CONTROLS (22K, 22)	104
HYDRAULIC CYLINDER, VALVE AND CONTROLS (22K, 22)	106

CYLINDER AND COMPONENT PARTS	108
SEQUENCE VALVE W/ ONE FRONT HYDRAULIC CYLINDER (22K, 22)	110
SEQUENCE AND SELECTOR VALVES	112
HYDRAULIC PULL BEHIND CYLINDER, BREAKAWAY COUPLING AND LINES	114
HYDRAULIC PULL BEHIND CYLINDER, BREAKAWAY COUPLING AND LINES	116
HYDRAULIC OIL PUMP, OIL TANK AND LINES	118
HYDRAULIC OIL PUMP, OIL TANK AND LINES	120

CYLINDER BLOCK, CYLINDER HEAD AND END PLATES

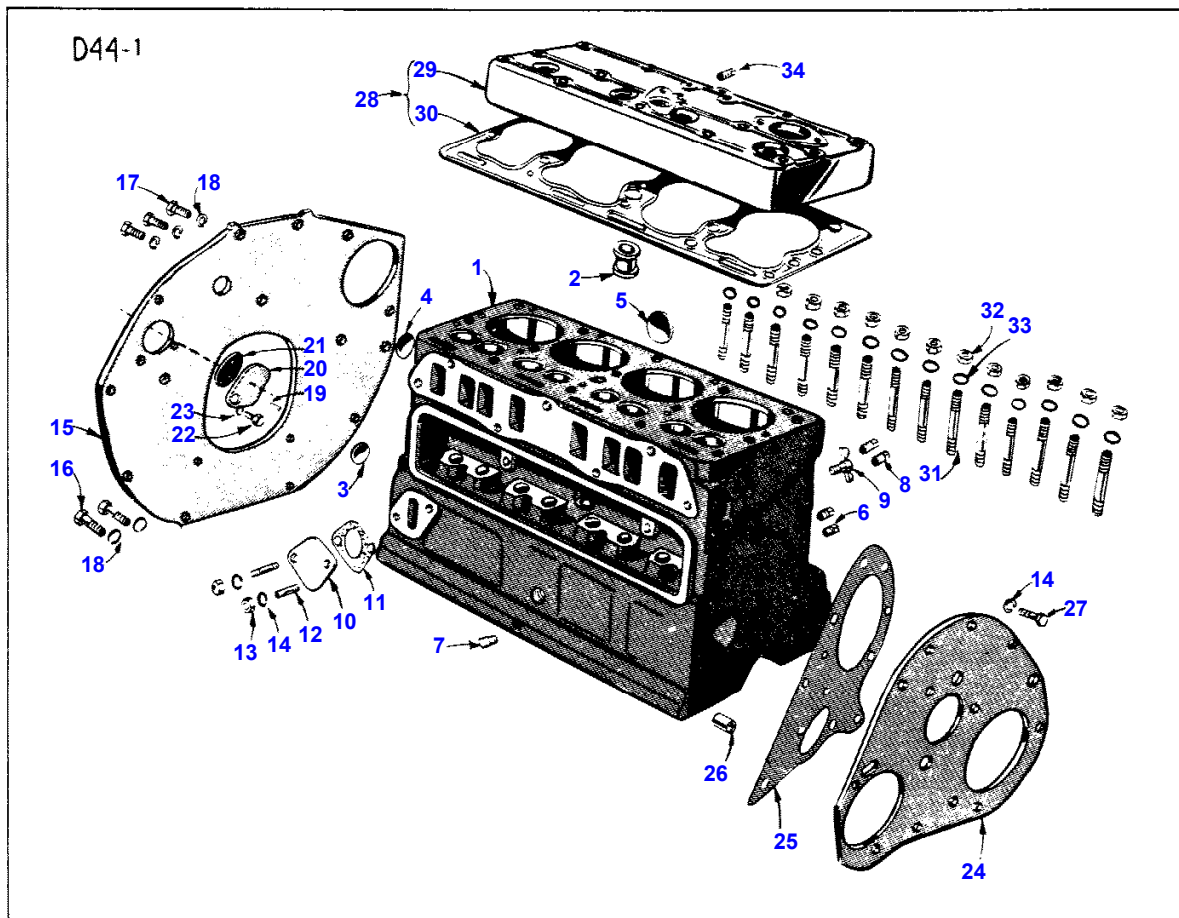

DO NOT ORDER FROM ILLUSTRATION REFERENCE NUMBER, ALWAYS REFER TO DESCRIPTIVE LIST  
UNNUMBERED PARTS IN ILLUSTRATION ARE THE SAME AS CORRESPONDING PARTS SHOWN WITH NUMBERS

## CYLINDER BLOCK, CYLINDER HEAD AND END PLATES

Item	Part Number	Qty	Description
			(SEE NOTE) (22K, 22)
			*****
1	1000622M91	1	(C) Cylinder Block Assembly (Stripped) (See Note)
	1000623M91	1	Cylinder Block Assembly (Equipped W/ Pistons, Rings, Pins, Valves, Valve Springs And Valve Tappets) (See Note)
	1000624M91	1	Cylinder Block Assembly (Equipped W/ Pistons, Rings, Pins, Conn. Rods, Crankshaft, Valves, Valve Springs, Valve Tappets, Camshaft, Timing Gears And Front End Plate) (See Note)
	760796M91	1	(C) Cylinder Block Assembly (Stripped) (See Note)
	760798M91	1	Cylinder Block Assembly (Equipped W/ Pistons, Rings, Pins, Valves, Valve Springs And Valve Tappets) (See Note)
	761108M91	1	Cylinder Block Assembly (Equipped W/ Pistons, Rings, Pins, Conn. Rods, Crankshaft, Valves, Valve Springs, Valve Tappets, Camshaft, Timing Gears And Front End Plates (See Note)
2	15242A	1	Bushing For Oil Pump Drive Shaft
3	13518X	1	Plug, Rear Camshaft Bearing Hole (1-1/2" Exp.)
4	1692X	1	Plug, Cylinder Core Holes (1-1/8" Exp)
5	1793X	1	Plug, Cylinder Core Holes (1-3/8" Exp.)
6	16242X	2	Plug, Oil Passage (1/4" Ctsk. Hd. Pipe)
7	2802X	1	Plug, Oil Passage ( 1/8" Slotted Hd. Pipe)
8	2410X	2	Plug, Water Jacket Drain (1/4" Sq. Hd. Pipe)
9	763716M1	1	Drain, Cock
10	17166A	1	Cover, Fuel Pump Hole
11	17165A	1	Gasket, Fuel Pump Hole Cover
12	21205A	2	Stud (5/16" NC x 1")
13	11922X	2	Nut (5/16" NC, Hex.)
14	2761X	3	Washer (5/16" Lock)
15	760785M1	1	Rear End Plate Only
16	15353A	1	Timing Pointer (# 10 x 3/4" Drive Screw)
17	15354A	1	Cover, Pointer Hole
18	17058A	1	Cover Felt
19	12782X	1	Bolt, Cover To Plate (3/8 x 5/8" NC, Hex.)
20	2762X	1	Washer (3/8" Lock)
21	15355A	2	Dowel Screw, Plate To Block
22	12408X	3	Bolt, Plate To Block (7/16 x 1" NC, Hex.)
23	2763X	5	Washer (7/16" Lock)
24	35248A	1	Front End Plate
25	760357M1	1	Gasket, End Plate To Block
26	15332A	1	Dowel, End Plate To Block
27	2425X	1	Bolt (5/16 x 3/4" NC, Hex.)
28	840202M91	1	Cylinder Head And Gasket Kit, Low Grade, Regular (5:1) 22K
29	760800M91	1	Cylinder Head Assembly (Order 840202M91) 22K
30	32648A	1	Gasket, Cylinder Head To Block
28	840203M91	1	(A) Cylinder Head And Gaskey Kit, Low Grade, he-Altitude (6.03:1) 22K
29	760838M91	1	Cylinder Head Assembly (Order 840203M91) 22K
30	32648A	1	Gasket, Cylinder Head To Block (22K)
28	840556M91	1	(B) Cylinder Head And Gasket Kit, Gas, Regular (6.50:1) 22K
29	760800M91	1	Cylinder Head Assembly (Order 840202M91) 22K
30	32648A	1	Gasket, Cylinder Head To Block (22K)
28	840203M91	1	(A) Cylinder Head And Gaskey Kit, Low Grade, Hi-Altitude (6.03:1)
29	760838M91	1	Cylinder Head Assembly (Order 840203M91) 22K
30	32648A	1	Gasket, Cylinder Head To Block (22K)
28	840556M91	1	(B) Cylinder Head And Gasket Kit, Gas, Regular (6.50:1) 22
29	760848M91	1	Cylinder Head Assembly (Order 840556M91) 22
30	32648A	1	Gasket, Cylinder Head To Block (22)
31	15248A	15	Stud, Cylinder Head To Block (7/16" NC-NF x 3-15/32") 22
	17162A	15	Stud, Cylinder Head To Block (7/16" NC-NF x 3-11/16")
32	15268A	15	Nut (7/16" NF, Hex.)
33	15269A	15	Washer (7/16" Special Flat)
34	19363X	1	Plug, Spring Retainer (1/2" P.T., Ctsk. Hd. Pipe) 22
			*****

Note: All Cylinder Blocks Are Equipped  
With All Studs, Plugs, Camshaft Bearing,  
Main Bearings And main Bearing Caps.  
(A) - Cylinder Head And Gasket Kit  
840203M91 Also Used On Gasoline Engines  
In 22 Tractors Prior To Engine Serial  
Number 19157. To Obtain higher

## CYLINDER BLOCK, CYLINDER HEAD AND END PLATES

Item	Part Number	Qty	Description
			Compression Ratio As Used On Current Engines, Can Be Replaced With 1 - 840556M91 Cylinder Head Kit Plus 1 - 15273A Distributor Drive Shaft.
			(B) - First Used Engine Serial Number 19157.
			(C) - Cylinder Block Assembly Numbers 1000622M91 And 760796M91 Are Less Pistons And Are Not Considered Normal Repair Items. They Are Intended To Be Used Only When Replacing Block In New Engines That Have Been Damaged By Freezing Or In Shipment.

## 8 CRANKSHAFT, MAIN BEARINGS AND CAPS, FILLER BLOCK AND FLYWHEEL

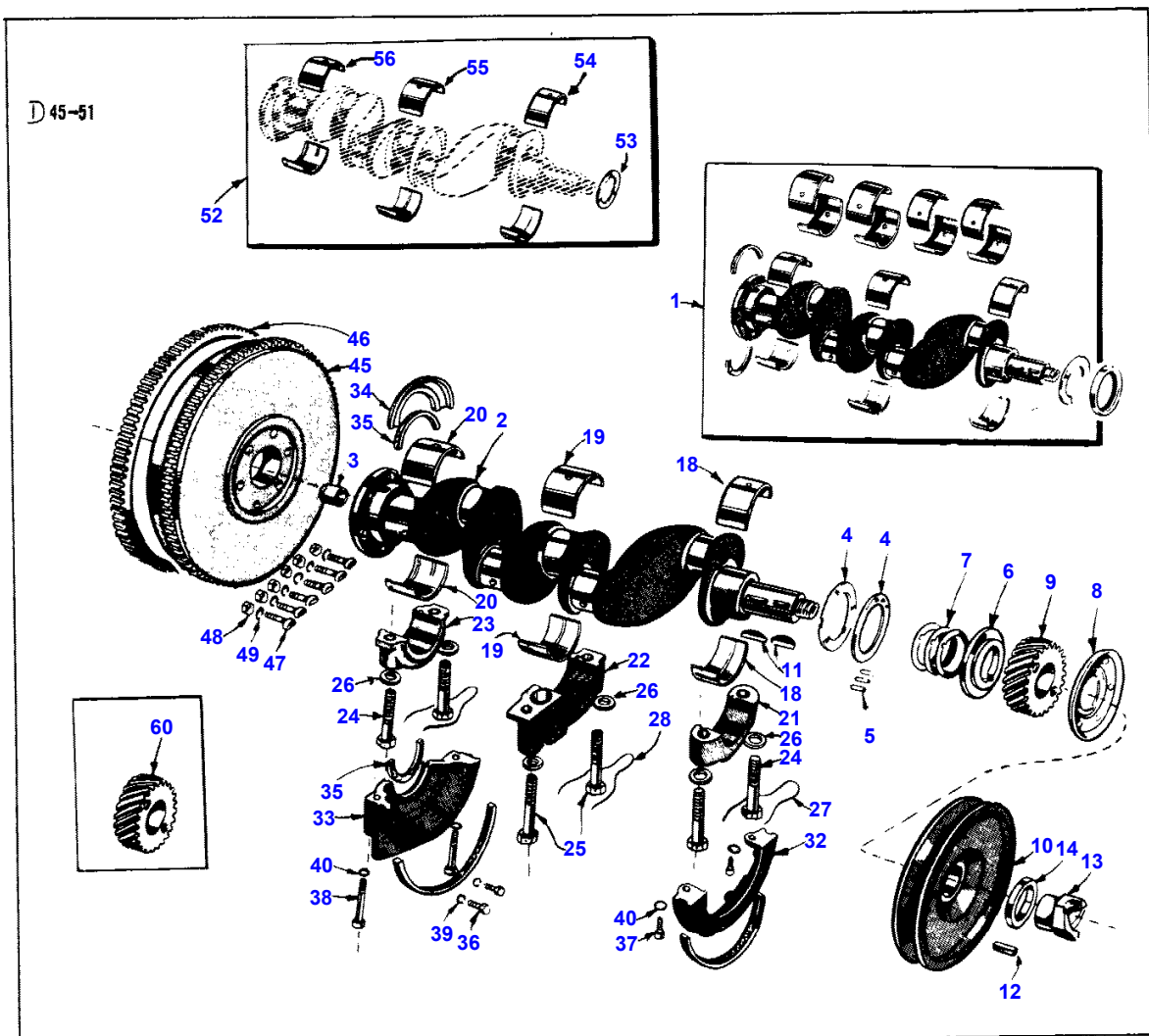

DO NOT ORDER FROM ILLUSTRATION REFERENCE NUMBER, ALWAYS REFER TO DESCRIPTIVE LIST  
 UNNUMBERED PARTS IN ILLUSTRATION ARE THE SAME AS CORRESPONDING PARTS SHOWN WITH NUMBERS

## CRANKSHAFT, MAIN BEARINGS AND CAPS,

Item	Part Number	Qty	Description
			FILLER BLOCK AND FLYWHEEL (USED ENGINE SERIAL NUMBERS (GAS) 29133, (LOW GRADE) 28564 AND UP) 22K, 22 *****
1	840477M91	1	Crankshaft And Bearing Kit (Incl. 1 - 32655A Crankshaft, 1 - 840473M91 Main Bearing Kit, 1 - 840087M91 Conn. Rod Bearing Kit, 1 - 15287A Oil Seal, 1 - 15288A Dust Seal And 2 - 1001408M1 Oil Seals)
2	32655A	1	Crankshaft Assembly (Order 840477M91)
3	15280A	1	Bushing, Crankshaft Pilot (5/8 x 13/16 x 3/4")
4	15285A	2	Washer, Thrust, (2-9/32 x 3-1/16 x 3/32")
5	15240A	3	Pin, Dowel Thrust Washer To Block
6	15281A	1	Plate, Thrust
7	15283A	AR	Shim, Thrust Plate (.002")
	15284A	AR	Shim, Thrust Plate (.004")
8	15286A	1	Thrower, Oil
9	32656A	1	Gear, Crankshaft Timing
10	33228A	1	Pulley, Fan Drive
11	12501X	2	Key (#15 Woodruff)
12	15291A	1	Plug, Keyway (Cork)
13	15289A	1	Jaw, Starting
14	15290A	1	Washer 91-3/8 x 2 x 1/4")
18	1000440M91	1	Main Bearing Assembly, Front (Incl. Upper And Lower Shells) (See 840473M91)
19	760353M91	1	Main Bearing Assembly, Center (Incl. Upper And Lower Shells) (See 840473M91)
20	760354M91	1	Main Bearing Assembly, Rear (Incl. Upper And Lower Shells) (See 840473M91)
21	1004860M1	1	Cap, Main Bearing, Front
22	1004863M1	1	Cap, Main Bearing, Center
23	1004862M1	1	Cap, Main Bearing, Rear
24	1004861M1	4	Bolt (1/2 x 2-5/8" NC, Hex., Drilled)
25	15235A	2	Bolt (1/2 x 3-1/4" NC, Hex., Drilled)
26	15233A	6	Washer (1/2" Flat, Special)
27	15234A	2	Wire, Lock (#19 - 10")
28	15236A	1	Wire, Lock (#19 - 12")
32	32674A	1	Filler Block, Front
33	6226A	1	Filler Block, Rear
34	32682A	1	Guard, Oil
35	1001408M1	2	Seal, Oil (Jute Yarn)
36	15227X	2	Bolt, Rear Filler Block (1/4 x 5/8" NC, Hex.)
37	22110X	2	Screw, Front Filler Block (5/16 x 7/8" NC, Socket Hd.)
38	22115X	2	Screw, Rear Filler Block (5/16 x 2-5/8" NC, Socket Hd.)
39	2760X	2	Washer (1/4" Lock)
40	15492X	4	Washer (5/16" Int. Skpf.)
45	32652A	1	Flywheel Assembly
46	32654A	1	Starter Ring Gear
47	15279A	6	Bolt, Flywheel To Crankshaft (3/8 x 1-3/16" NF, Special)
48	12177X	6	Nut (3/8" NF, Hex.)
49	15200X	6	Washer (3/8" Int. Skpf.)
52	840473M91	1	Bearing Set, Main Std.
53	15285A	1	Washer, Thrust, (2-9/32 x 3-1/16 x 3/32")
54	1000440M91	1	Bearing Assembly, Front Main Std.
55	760353M91	1	Bearing Assembly, Center Main Std.
56	760354M91	1	Bearing Assembly, Rear Main Std.
52	840474M91	1	Bearing Set, Main, - .002"
53	15285A	1	Washer, Thrust, (2-9/32 x 3-1/16 x 3/32")
54	1000441M91	1	Bearing Assembly, Front Main, - .002"
55	34407A	1	Bearing Assembly, Center Main, - .002"
56	34412A	1	Bearing Assembly, Rear Main, - .002"
52	840475M91	1	Bearing Set, Main, - .020"
53	15285A	1	Washer, Thrust, (2-9/32 x 3-1/16 x 3/32")
54	1000442M91	1	Bearing Assembly, Front Main, - .020"
55	34411A	1	Bearing Assembly, Center Main, - .020"
56	34416A	1	Bearing Assembly, Rear Main, - .020"
52	840476M91	1	Bearing Set, Main, - .040"
53	15285A	1	Washer, Thrust, (2-9/32 x 3-1/16 x 3/32")
54	1000443M91	1	Bearing Assembly, Front Main, - .040"
55	35407A	1	Bearing Assembly, Center Main, - .40"
56	35408A	1	Bearing Assembly, Rear Main, - .040"
60	1004126M1	AR	(A) Gear, Crankshaft Timing (-.001")

## CRANKSHAFT, MAIN BEARINGS AND CAPS,

Item	Part Number	Qty	Description
	1004127M1	AR	(A) Gear, Crankshaft Timing (-.002")
	1004128M1	AR	(A) Gear, Crankshaft Timing (-.003")
	1004129M1	AR	(A) Gear, Crankshaft Timing (-.004")
	1004130M1	AR	(A) Gear, Crankshaft Timing (-.005")
	1004131M1	AR	(A) Gear, Crankshaft Timing (-.006")
	1004132M1	AR	(A) Gear, Crankshaft Timing (+.001")
	1004133M1	AR	(A) Gear, Crankshaft Timing (+.002")
	1004134M1	AR	(A) Gear, Crankshaft Timing (+.003")
	1004135M1	AR	(A) Gear, Crankshaft Timing (+.004")
	1004136M1	AR	(A) Gear, Crankshaft Timing (+.005")
	1004137M1	AR	(A) Gear, Crankshaft Timing (+.006")

\*\*\*\*\*

(A) - Undersize And Oversize Gears Are  
Furnished On Special Order When Needed  
To Obtain Quiet Gear Operation.