

Page Title	Page Number
CYLINDER BLOCK, TIMING GEAR COVER, PUMP ADAPTER	4
CRANKSHAFT, MAIN BEARINGS, FLYWHEEL	6
SLEEVES, PISTONS, RINGS, PINS AND CONNECTING RODS	8
CYLINDER HEAD, VALVES, CAMSHAFT	10
ENGINE GASKETS AND SEALS	12
OIL PUMP, OIL PAN, BAYONETTE GAUGE	14
OIL FILTER AND LINES, PRESSURE GAUGE AND LINES	16
WATER PUMP, FAN AND BELT	18
RADIATOR AND ATTACHING PARTS, THERMOSTAT	20
RADIATOR SHUTTERS AND CONTROLS	22
MANIFOLD, MUFFLER, AIR CLEANER, INJECTION NOZZLES,	24
COLD WEATHER STARTING AIDS	26
THROTTLE AND CONTROLS, GOVERNOR	28
P.S.B. INJECTION PUMP AND LINES, ADAPTER AND DRIVE	30
FUEL FILTERS AND LINES	32
BATTERY BOX AND SUPPORTS, FUEL TANK AND SUPPORTS,	34
CABLES AND WIRES, SOLENOID, IGNITION COIL, CIRCUIT BREAKER,	36
INSTRUMENT PANEL AND INSTRUMENTS, PRIMER PUMP AND LINES,	40
GENERATOR AND VOLTAGE REGULATOR	42
STARTER	44
LIGHTING EQUIPMENT	46
LIGHTING EQUIPMENT (LAMPS)	48
FRONT AXLE AND SUPPORT, SPINDLES, TIE ROD (STANDARD)	50
FRONT AXLE AND SUPPORT	52
FRONT AXLE AND SUPPORT, SPINDLES TIE ROD	54
FRONT AXLE AND SUPPORT, SPINDLES, TIE ROD	56
FRONT AXLE AND SUPPORT, SPINDLES, TIE ROD	58
STEERING GEAR (STANDARD)	60
STEERING GEAR (STANDARD)	62
STEERING GEAR (ROW CROP)	64
STEERING GEAR (ROW CROP)	66
STEERING GEAR (HI-ARCH)	68
STEERING GEAR (HI-ARCH)	70
STEERING GEAR (SINGLE FRONT WHEEL)	72
STEERING GEAR (SINGLE FRONT WHEEL)	74
TRANSMISSION CASE AND FRAME	76
CLUTCH AND CLUTCH SHAFT	78
CLUTCH HOUSING AND CONTROL	80
TRANSMISSION	82
POWER TAKE-OFF AND DRIVE, BELT PULLEY DRIVE	84
TRANSMISSION COVER AND CONTROLS	86
CLUTCH AND CLUTCH CONTROLS (LIVE P.T.O.)	88
DIFFERENTIAL (LIVE P.T.O.)	90
DIFFERENTIAL (REGULAR P.T.O.)	92
REAR AXLES AND MASTER GEARS	94
BRAKES (LIVE P.T.O.)	96
BRAKES (REGULAR P.T.O.)	98
WHEELS, FRONT (RUBBER TIRE)	100
WHEELS, REAR (RUBBER TIRE)	102
WHEELS, FRONT (STEEL)	104

WHEELS, REAR (STEEL)	106
HOOD, RADIATOR GRILLE AND SUPPORT, DECALS,	108
SEAT	110
DRAWBAR	112
POWER TAKE-OFF, TOOL BOX AND TOOLS	114
HITCH-ALL	116

33 DIESEL TRACTOR

6

CRANKSHAFT, MAIN BEARINGS, FLYWHEEL

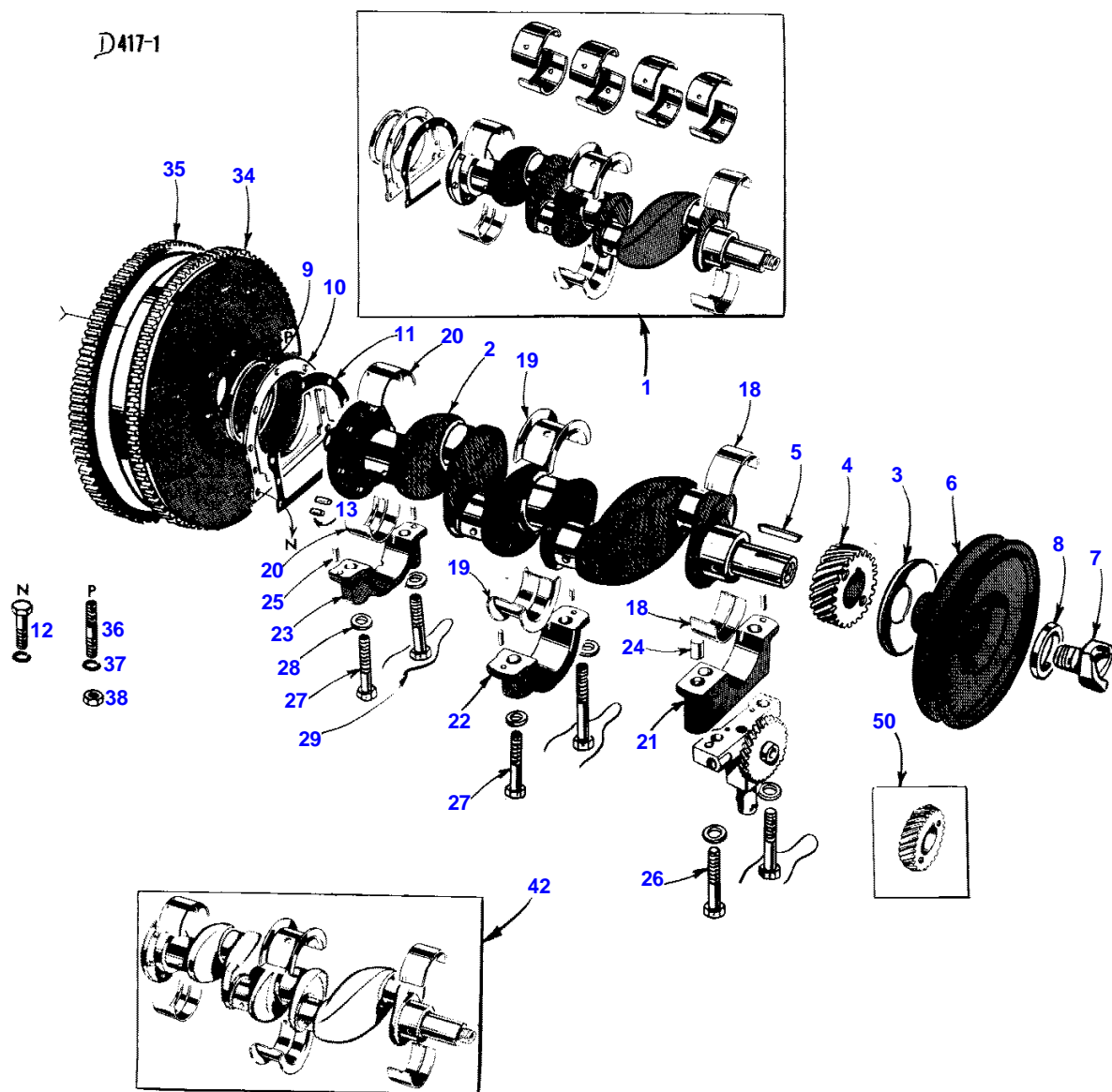

Item	Part Number	Qty	Description
1	841172M91	1	Crankshaaf And Insert Kit (Inc. 1 - 1007505M1, 1 - 841173M91, 1 - 841168M91, 1 - 17627A, 1 - 1-8938M1 And 1 - 1005883M1)
2	1007505M1	1	Crankshaft (Order 841172M91)
3	1005881M1	1	Washer, Oil Throw-Off
4	1005885M1	1	Gear, Crankshaft Timing, (Std.) (See Item #50)
5	760426M1	1	Key, Timing Gear
6	1005943M1	1	Pulley, Fan Drive
7	760412M1	1	Jaw, Crankshaft Starting
8	760413M1	1	Washer, Starting Jaw
9	1008938M1	1	Seal, Oil, Rear (4-7/16 x 5-17/64 x 7/16")
10	1005884M1	1	Retainer, Oil Seal
11	1005883M1	1	Gasket, Retainer
12	21216A	7	Bolt Assembly W/Washer (516 x 3/4" NC, Hex.)
13	760402M1	2	Dowel (1/4 x 15/32")
18	1007506M91	1	Insert Assembly, Front Crankshaft Bearing (See Item #42)
19	1007509M91	1	Insert Assembly, Center Crankshaft Bearing (See Item #42)
20	1007511M91	1	Insert Assembly, Rear Crankshaft Bearing (See Item #42)
21	1005847M1	1	Cap, Front Main Bearing
22	1005848M1	1	Cap, Center Main Bearing
23	1005849M1	1	Cap, Rear Main Bearing
24	17170A	1	Dowel, Ring, Front Bearing Cap
25	760402M1	3	Dowel (1/4 x 15/32")
26	761533M1	2	Bolt, Front Bearing Cap (Also Holds Oil Pump) (9/16 x 4-1/2" NC, Hex., Dld. Hd.)
27	760398M1	4	Bolt, Center And Rear Bearing Cap (9/16 x 3" NC, Hex., Dld. Hd.)
28	1007519M1	6	Washer, Bearing Cap Bolts (19/32 X 1 x 3/16")
29	17862A	3	Wire, Lock Bearing Cap Bolts
34	1007530M91	1	Flywheel Assembly
35	1000804M1	1	Gear, Ring, Flywheel Starting
36	1007710M1	6	Stud, Flywheel (3/8" NF x 2-1/8")
37	2762X	6	Washer (3/8" Lock)
38	12177X	6	Nut, (3/8" NF, Hex.)
42	841173M91	AR	Insert Kit, Crankshaft Bearing, Std.
	1007506M91	1	Insert Assembly, Crankshaft Bearing, Front
	1007509M91	1	Insert Assembly, Crankshaft Bearing, Center
	1007511M91	1	Insert Assembly, Crankshaft Bearing, Rear
42	841174M91	AR	Insert Kit, Crankshaft Bearing, -.002"
	1007737M91	1	Insert Assembly, Crankshaft Bearing, Front
	1007740M91	1	Insert Assembly, Crankshaft Bearing, Center
	1007742M1	1	Insert Assembly, Crankshaft Bearing, Rear
42	841260M91	AR	Insert Kit, Crankshaft Bearing, -.010"
	1008569M91	1	Insert Assembly, Crankshaft Bearing, Front
	1008572M91	1	Insert Assembly, Crankshaft Bearing, Center
	1008574M91	1	Insert Assembly, Crankshaft Bearing, Rear
42	841175M91	AR	Insert Kit, Crankshaft Bearing, -.020"
	1007745M91	1	Insert Assembly, Crankshaft Bearing, Front
	1007748M91	1	Insert Assembly, Crankshaft Bearing, Center
	1007750M91	1	Insert Assembly, Crankshaft Bearing, Rear
50	1005886M1	AR	(A) Gear, Crankshaft Timing, -.001", Marked 1
	1005887M1	AR	(A) Gear, Crankshaft Timing, -.002", Marked 2
	1005888M1	AR	(A) Gear, Crankshaft Timing, -.003", Marked 3
	1005890M1	AR	(A) Gear, Crankshaft Timing, -.004", Marked 4
	1005890M1	AR	(A) Gear, Crankshaft Timing, -.004", Marked 5
	1005891M1	AR	(A) Gear, Crankshaft Timing, -.006", Marked 6
	1005892M1	AR	(A) Gear, Crankshaft Timing, +.001", Marked 1
	1005893M1	AR	(A) Gear, Crankshaft Timing, +.002", Marked 2
	1005894M1	AR	(A) Gear, Crankshaft Timing, +.003", Marked 3
	1005895M1	AR	(A) Gear, Crankshaft Timing, +.004", Marked 4
	1005896M1	AR	(A) Gear, Crankshaft Timing, +.005", Marked 5
	1005897M1	AR	(A) Gear, Crankshaft Timing, +.006", Marked 6

(A) - Undersize And Oversize Gears Are
Furnished On Special Order To Obtain
Quiet Gear Operation.

4

CYLINDER BLOCK, TIMING GEAR COVER, PUMP ADAPTER

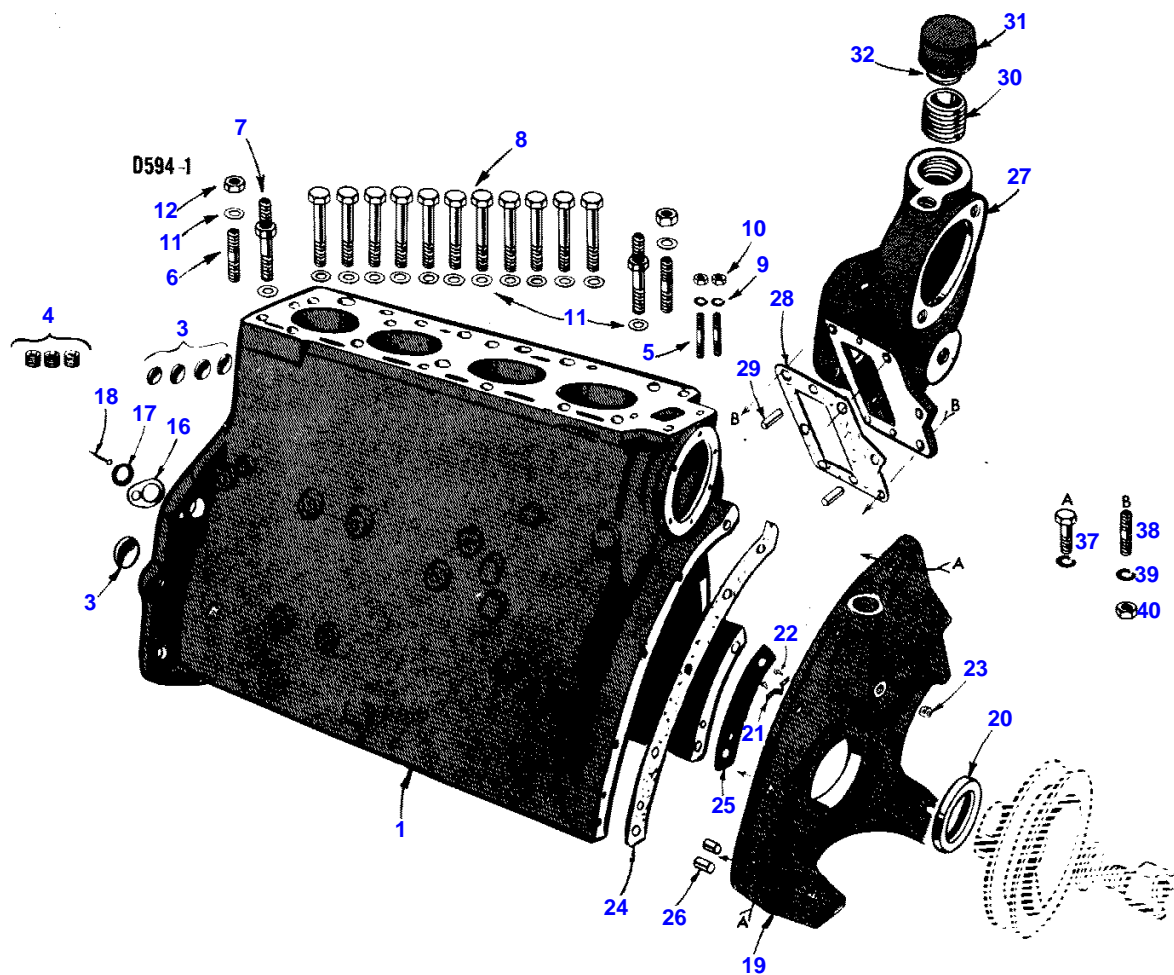

Item	Part Number	Qty	Description
	1007762M91	1	Block Assembly, Cylinder (Inc. All Studs, Plugs, Main Bearing And Caps, Piston Assembly, Connecting Rod Assembly, Crankshaft, Camshaft And Timing Gears)
1	1007722M91	1	Block Assembly, Cylinder (Inc. All Studs, Plugs And Main Bearing Caps)
	1003010M1	2	Plug, Heater Hole (1-5/8" Cup Type)
3	14708X	5	Plug, Block (2" Expansion)
4	1000148M1	3	Plug (1/4" P.T. Sckt. Hd.)
5	15247A	2	Stud (3/8" NC x 1-11/16")
6	1007667M1	2	Stud (1/2" NC x 2-1/2")
7	1007520M1	2	Stud (1/2" NC-9/16" NF x 7-1/8")
8	1007526M1	11	Bolt (1/2" x 5-3/4" NC)
9	2762X	2	Washer (3/8" Lock)
10	11923X	2	Nut (3/8" NC, Hex.)
11	1005923M1	15	Washer (17/32 x 15/16 x 1/8")
12	2638X	2	Nut (1/2" NC, Hex.)
16	15354A	1	Cover, Timing Hole
17	17058A	1	Felt, Timing Hole Cover
18	1005946M1	1	Pointer, Flywheel Timing
19	1005906M91	1	Cover Assembly, Timing Gears
20	17627A	1	Seal, Oil, Crankshaft, Front (2-3/8 x 3-3/8 x 15/32")
21	760137M1	1	Spring, Governor Bumper
22	16863X	2	Rivet, Bumper Spring (1/8 x 7/16 Rd. Hd.)
23	22596X	1	Plug, Governor Lever Boss (1/8" Pipe, Socket Hd.)
24	1005908M1	1	Gasket, Timing Gear Cover (Long)
25	1005909M1	1	Gasket, Timing Gear Cover (Short)
26	760028M1	2	Dowel, Timing Gear Cover (3/8 x 3/4")
27	1007688M1	1	Adapter, Injection Pump
28	760017M1	1	Gasket, Adapter To Block
29	760028M1	2	Pin, Adapter To Block (3/8 x 3/4")
30	1006041M1	1	Pipe, Oil Filler (1-1/4" Pipe x 2-1/2")
31	1005067M1	1	Cap Assembly, Oil Filler, W/Seal
32	1005068M1	1	Gasket, Filler Cap
37	22727X	AR	Bolt Assembly W/Washer (3/8 x 1" NC, Hex.)
38	21207A	AR	Stud (3/8" NC x 1-1/2")
39	2762X	AR	Washer (3/8" Lock)
40	11923X	AR	Nut (3/8" NC, Hex.)