

Page Title	Page Number
CYLINDER BLOCK, TIMING GEAR COVER, OIL FILLER COVER	4
CYLINDER BLOCK, TIMING GEAR COVER, INJECTION PUMP ADAPTER	6
CYLINDER BLOCK, TIMING GEAR COVER, INJECTION PUMP ADAPTER	8
CYLINDER BLOCK, TIMING GEAR COVER, INJECTION PUMP ADAPTER	10
CRANKSHAFT, MAIN BEARINGS FLYWHEEL (GAS, KEROSENE AND L.P.)	12
CRANKSHAFT, MAIN BEARINGS FLYWHEEL (DIESEL)	14
SLEEVES, PISTONS, RINGS AND CONNECTING RODS	16
SLEEVES, PISTONS, RINGS, PINS AND CONNECTING RODS (DIESEL)	18
CYLINDER HEAD, VALVES AND CAMSHAFT (GAS, KEROSENE AND L.P.)	20
CYLINDER HEAD, VALVES AND CAMSHAFT (DIESEL)	22
ENGINE GASKETS AND SEALS (GAS, KEROSENE AND L.P.)	24
ENGINE GASKETS AND SEALS (DIESEL)	26
OIL PUMP, OIL PAN, BAYONETTE GAUGE	28
OIL FILTER, PRESSURE GAUGE AND LINES	30
WATER PUMP, FAN AND CRANK (GAS, KEROSENE, L.P. AND DIESEL)	32
RADIATOR, SUPPORT, THERMOSTAT, SHUTTERS AND CONTROLS	34
MANIFOLD, MUFFLER, AIR CLEANER, INJECTION NOZZLES,	36
COLD WEATHER STARTING AIDS (BLOCK HEATER)	38
GOVERNOR, THROTTLE, CHOKE (GAS, KEROSENE, L.P.)	40
GOVERNOR, THROTTLE (USE W/P.S.B. PUMP) (DIESEL)	42
FUEL TANK AND SUPPORTS, SEDIMENT BOWL AND LINES	44
FUEL TANK AND SUPPORTS, SEDIMENT BOWL AND LINES (DIESEL)	46
FUEL TANK AND SUPPORTS, FUEL VALVES AND LINES (L.P.)	48
FUEL REGULATOR, FUEL FILTER (L.P.)	50
P.S.B INJECTION PUMP, ADAPTER AND LINES (DIESEL)	52
P.S.B INJECTION PUMP, ADAPTER AND LINES (DIESEL)	54
A.P.E. INJECTION PUMP, ADAPTER AND LINES (DIESEL)	56
FUEL FILTERS AND LINES (DIESEL)	58
CARBURETER (GAS)	60
CARBURETER (KEROSENE)	62
CARBURETER (L.P.)	64
INSTRUMENT PANEL AND INSTRUMENTS, FUEL PUMP SHUT-OFF	66
BATTERY BOX, CABLES, CIRCUIT BREAKER, SOLENOID, WIRES,	68
BATTERY BOX AND SUPPORTS, SOLENOID, CABLES AND WIRES	70
DISTRIBUTOR (GAS, L.P.)	72
DISTRIBUTOR (KEROSENE)	74
GENERATOR AND VOLTAGE REGULATOR	76
STARTER (GAS, KEROSENE)	78
STARTER (L.P.)	80
STARTER (DIESEL)	82
LIGHTING EQUIPMENT (GAS, KEROSENE, L.P., DIESEL)	84
LIGHTING EQUIPMENT (LAMPS)	86
LIGHTING EQUIPMENT (LAMPS)	88
FRONT AXLE AND SUPPORT, SPINDLES, TIE ROD (STANDARD AXLE)	90
FRONT AXLE AND SUPPORT, SPINDLES, TIE ROD (WIDE AXLE)	92
STEERING GEAR, DRAG LINK (STANDARD AXLE)	94
STEERING GEAR, DRAG LINK (STANDARD AXLE)	98
STEERING GEAR, DRAG LINK (WIDE AXLE)	96
STEERING GEAR, DRAG LINK (WIDE AXLE)	100
HYDRAULIC CYLINDER AND SUPPORT	102

HYDRAULIC PUMP AND LINES, BELTS AND PULLEYS	104
TRANSMISSION CASE AND FRAME (GAS, KEROSENE, L.P., DIESEL)	106
CLUTCH AND CLUTCH SHAFT (FOOT OPERATED)	108
CLUTCH AND CLUTCH SHAFT (FOOT OPERATED)	112
CLUTCH HOUSING AND CONTROLS	110
CLUTCH HOUSING AND CONTROL	114
TRANSMISSION (GAS, KEROSENE, L.P., DIESEL)	116
REAR AXLE, MASTER GEARS, HOUSING	118
GEAR SHIFT (GASOLINE, KEROSENE, L.P. DIESEL)	120
POWER TAKE-OFF, BELT PULLEY AND DRIVE	122
DIFFERENTIAL (GASOLINE, KEROSENE, L.P., DIESEL)	124
BRAKES (GASOLINE, KEROSENE, L.P., DIESEL)	126
WHEELS, FRONT (RUBBER TIRE)	128
WHEELS, REAR (RUBBER TIRE) (USED W/STANDARD AXLE)	130
HOOD, RADIATOR GRILLE AND SUPPORT, DECALS	132
FENDERS AND PLATFORMS (GASOLINE, KEROSENE, L.P., DIESEL)	134
SEAT (GASOLINE, KEROSENE, L.P., DIESEL)	136
DRAWBAR (GASOLINE, KEROSENE, L.P. DIESEL)	138
POWER TAKE-OFF (GASOLINE, KEROSENE, L.P. DIESEL)	140

D571-1

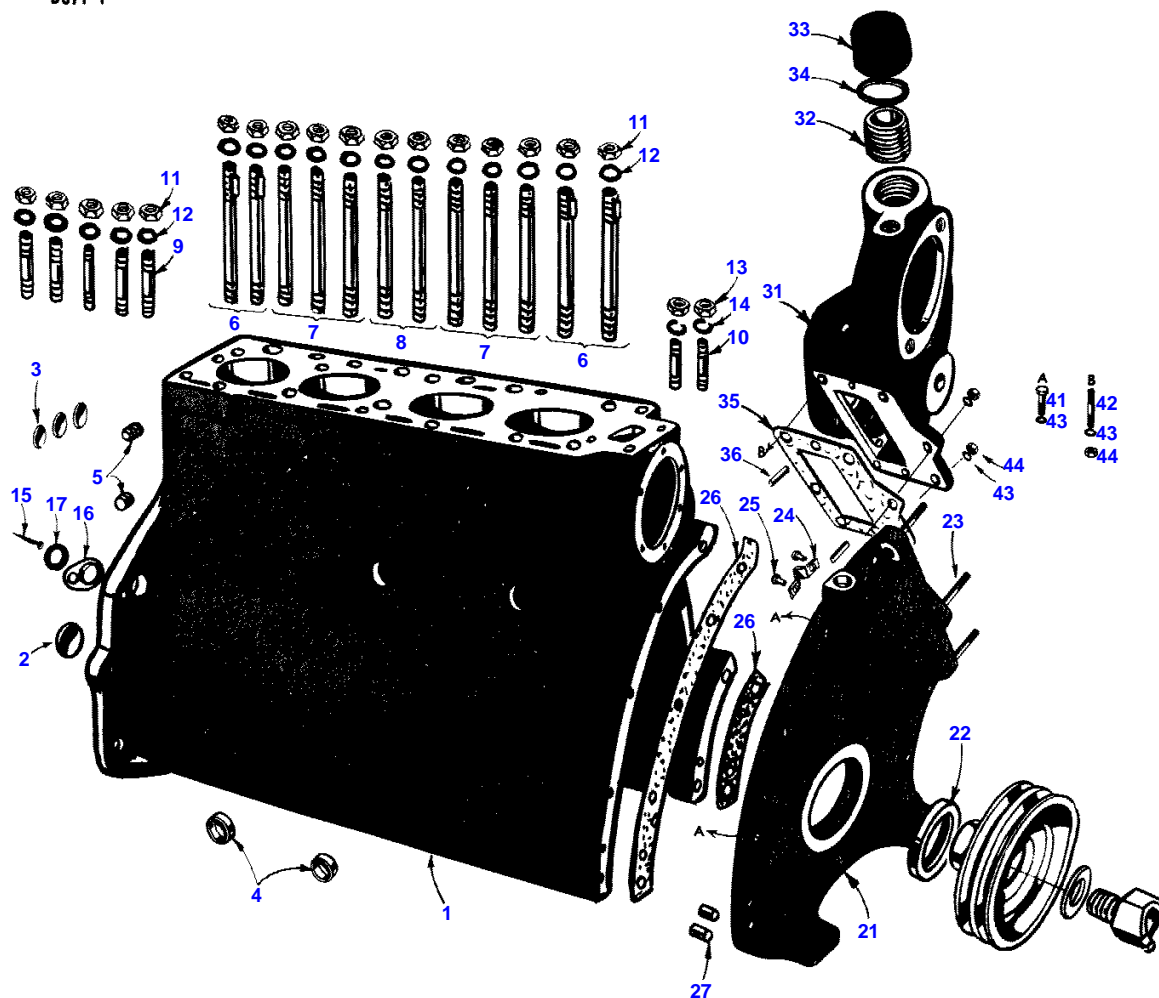

Item	Part Number	Qty	Description
			(USED W/P.S.B. PUMP) (USED ENGINE SERIAL NUMBER 11900 AND UP) (DIESEL) *****
	1007538M92	1	Block Assembly, Cylinder (Inc. Sleeves, Pistons, Rings, Pin, Connecting Rods, Main Bearings, Crankshaft, Camshaft And Timing Gears)
1	1007540M92	1	Block Assembly, Cylinder (Inc. All Studs, Plugs And Main Bearings)
2	11338X	1	Plug (2-1/4" Expansion)
3	14708X	3	Plug (2" Expansion)
4	1003010M1	2	Plug, Heater Hole (1-5/8" Cup Type)
5	1000148M1	2	Plug (1/4" P.T. Sckt. Hd.)
6	1006805M1	4	Stud (9/16" NC-NF x 7-1/8", W/Nylock Insert)
7	760401M1	6	Stud (9/16" NC-NF x 7-1/8", Plain)
8	760507M1	2	Stud (9/16" NC-NF x 6-11/16")
9	1004941M1	5	Stud (9/16" NC-NF x 3")
10	15247A	2	Stud (3/8" NC x 1-11/16")
	1000806M1	1	Plug (Distributor Hole) (1-1/16" Cup Type)
11	1000317M1	17	Nut (9/16" NF, Hex.)
12	1001252M1	17	Washer (9/16" Special)
13	11923X	2	Nut (3/8" NC, Hex.)
14	2762X	2	Washer (3/8" Lock)
15	760166M1	1	Pointer, Flywheel Timing
16	15354A	1	Cover, Timing Hole
17	17058A	1	Felt, Timing Hole Cover
21	1009942M91	1	Cover Assembly, Timing Gear
22	17627A	1	Seal, Oil (2-3/8 x 3-23/64 x 15/32")
23	21207A	3	Stud (3/8" NC x 1-1/2")
24	760137M1	1	Spring, Governor Bumper
25	16863X	2	Rivet, Bumper Spring (1/8 x 7/16")
26	1001883M1	1	Gasket, Timing Gear Cover
27	760028M1	2	Pin, Cover To Block (3/8 x 3/4")
31	1005618M1	1	Adapter, Injection Pump
32	1006041M1	1	Pipe, Oil Filler
33	1005067M1	1	Cap, Oil Filler Pipe
34	1005068M1	1	Gasket, Oil Filler Cap
35	760017M1	1	Gasket, Adapter To Block
36	760028M1	2	Pin, Adapter To Block (3/8 x 3/4")
41	2426X	AR	Bolt (3/8 x 1" NC, Hex.)
42	21207A	AR	Stud (3/8" NC x 1-1/2")
43	2762X	AR	Washer (3/8" Lock)
44	11923X	AR	Nut (3/8" NC, Hex.)

CYLINDER BLOCK, TIMING GEAR COVER, OIL FILLER COVER

01-53

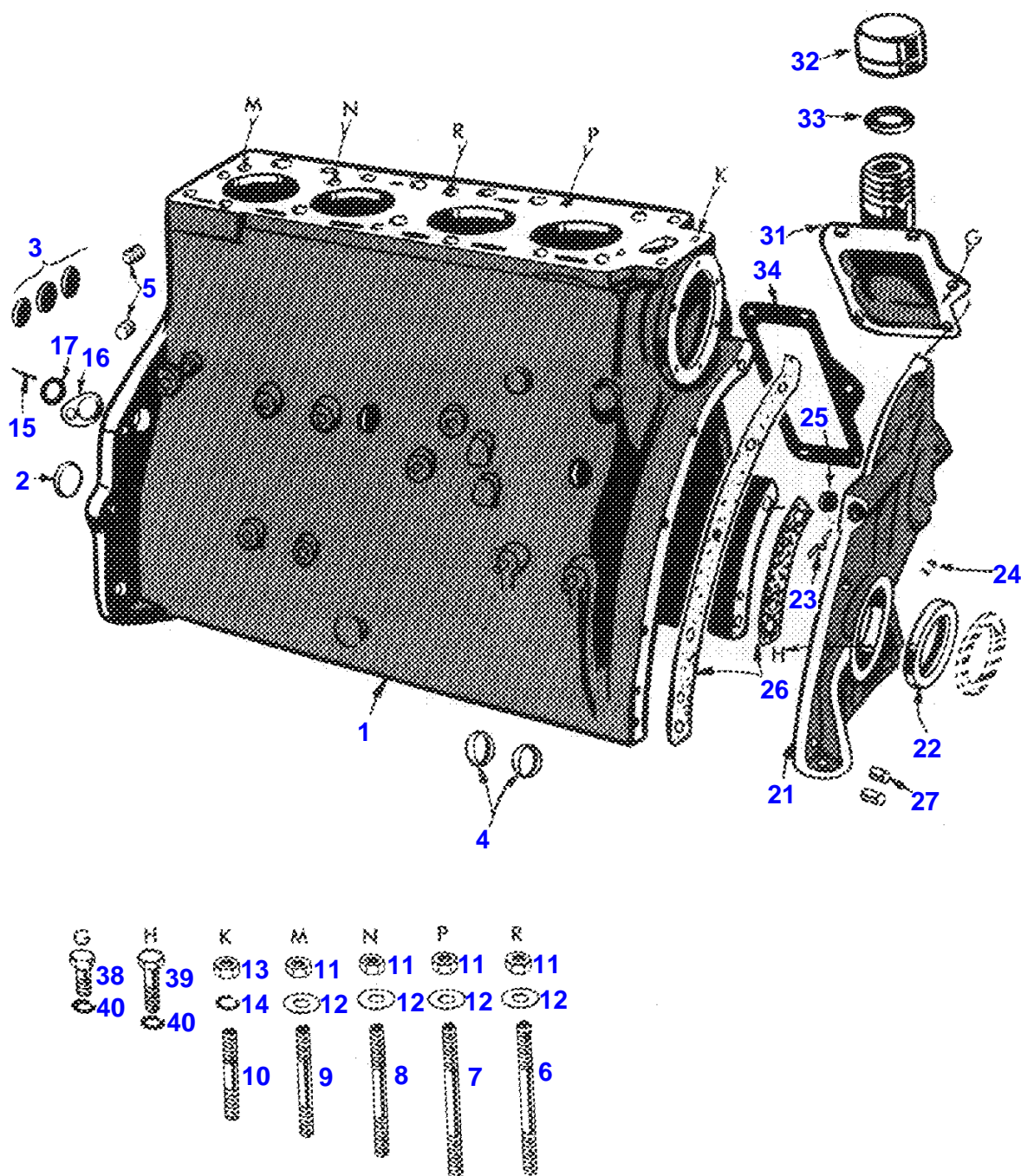

CYLINDER BLOCK, TIMING GEAR COVER, OIL FILLER COVER

Item	Part Number	Qty	Description (GAS, KEROSENE AND L.P.) *****
1	1007564M91	1	Block Assembly, Cylinder (Includes All Studs, Plugs And Main Bearings Caps, Less Sleeves And Main Bearings)
2	11338X	1	Plug (2-1/4" Expansion)
3	14708X	3	Plug (2" Expansion)
4	1003010M1	2	Plug, Heater Hole (1-5/8" Cup Type)
5	1000148M1	2	Plug (1/4" P.T. Sckt. Hd.)
6	1006805M1	4	Stud (9/16" NC-NF x 7-1/8", W/Nylock Insert)
7	760401M1	6	Stud (9/16" NC-NF x 7-1/8", Plain)
8	760507M1	2	Stud (9/16" NC-NF x 6-11/16")
9	1000333M1	5	Stud (9/16" NC-NF x 2-3/8")
10	15247A	2	Stud (3/8" NC x 1-11/16")
11	1000317M1	17	Nut (9/16" NF, Hex.- Special)
12	1001252M1	17	Washer (19/32 x 1 x 1/8")
13	11923X	2	Nut (3/8" NC, Hex.)
14	2762X	2	Washer (3/8" Lock)
15	760166M1	1	Pointer, Flywheel Timing
16	15354A	1	Cover, Timing Hole
17	17058A	1	Felt, Timing Hole Cover
21	1001881M91	1	Cover Assembly, Timing Gears
22	17627A	1	Seal, Oil (2-3/8 x 3-23/64 x 15/32")
23	760132M1	1	Spring, Governor Bumper
24	16863X	2	Rivet, Bumper Spring (1/8 x 7/16")
25	22596X	1	Plug, Cover (1/8" Pipe, Ctsk. Hd.)
26	1001883M1	1	Gasket, Gear Cover To Block
27	760028M1	2	Pin, Cover To Block (3/8 x 1")
31	1005065M91	1	Cover Assembly, Oil Filler
32	1005067M1	1	Cap, Oil Filler Cover Tube
33	1005068M1	1	Gasket, Oil Filler Cap
34	760432M2	1	Gasket, Cover To Block
38	12782X	AR	Bolt (3/8 x 5/8" NC, Hex.)
39	2426X	AR	Bolt (3/8 x 1" NC, Hex.)
40	2762X	AR	Washer (3/8" Lock)