

Service Manual

Fuel Cell System-Installation

C95A-33

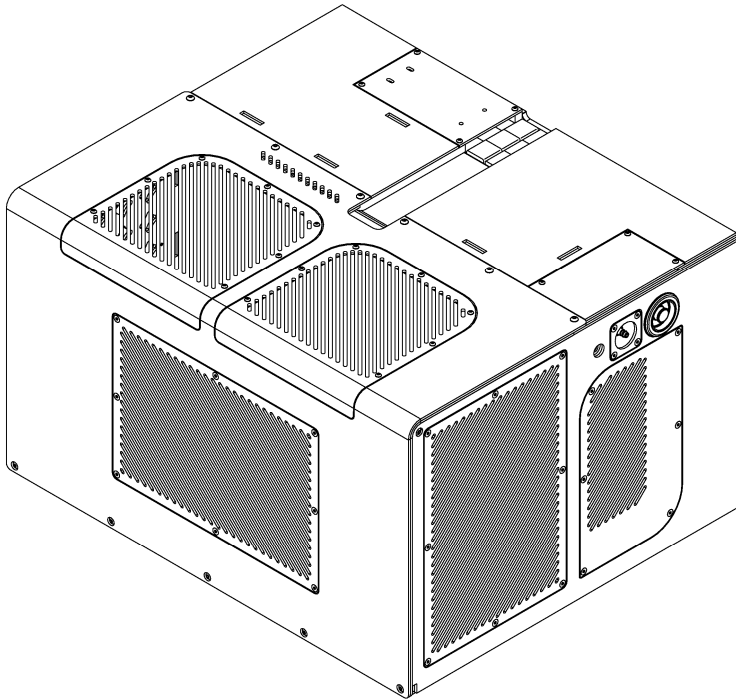

NUMERA®



31001933 | **04/2017**

NOTICE OF PROPRIETARY PROPERTY

This document and the information contained in it are the proprietary property of Nuvera Fuel Cells LLC. This document is intended solely for the internal use of the recipient and may not be used outside the recipient's organization nor distributed to third parties without the express prior written consent of Nuvera Fuel Cells LLC.

© Nuvera Fuel Cells, LLC. 2017 All rights reserved.

Table of Contents

General Information

Safety information.	1
General hazards, warnings, and cautionary statements.	2

About the Nuvera® Fuel Cell System

Components of the Nuvera® Fuel Cell System.	4
Warning labels.	5

Removal and Installation of the Nuvera® Fuel Cell System

Removing the fuel cell system.	7
Scope.	7
Safety and warnings.	7
Tools required.	7
Remove.	7
Removing the lifting eye plate from the main cover.	11
Scope.	11
Safety and warnings.	11
Tools required.	11
Discharge ultracapacitors.	11
Remove main cover.	11
Remove and replace lifting eye plate.	12
Install main cover.	13
Receiving and inspecting a new fuel cell.	14
Scope.	14
Safety and warnings.	14
Tools required.	14
Initial receiving.	14
Prepare fuel cell system.	15
Verifying operation via Nuvera® Fuel Cell System Service Tool.	16
Installing the fuel cell system.	20
Safety and warnings.	20
Tools required.	20
Install.	20
Opening shutoff valves.	24
Connecting the HMI, E-Stop, and EWS.	26
Safety and warnings.	26

Contents

Removal and Installation of the Nuvera® Fuel Cell System

Parts and materials required. 26

Connect the HMI and E-Stop. 26

Connect the Early Warning System. 26

List of Figures

Figure	Title	Page
1	External fuel cell system components.	4
2	Nameplate.	5
3	Nuvera® Fuel Cell System warning labels.	6
4	Battery connector and cable.	8
5	Lifting eyes: High pressure compartment.	8
6	Inspect threads.	8
7	Lifting eyes: Low pressure compartment.	9
8	Lifting eyes installed.	9
9	Attaching chain to lifting eyes.	10
10	Lifting strap and overhead guard.	10
11	Remove/Install main cover.	12
12	Attach lifting chain to remove main cover.	12
13	Lifting eyes: Low pressure compartment.	13
14	Inspect new fuel cell system.	14
15	Cover bolts.	15
16	Inspect lifting eyes.	15
17	Remove high pressure compartment access panel.	16
18	Storage tank shutoff valve.	16
19	Start system into Off mode.	17
20	System is in 'off' mode.	17
21	Pressurize H2 plumbing.	17
22	Pressurize H2 prompt.	18
23	Anode Loop Leak Check.	18
24	Anode loop leak check prompt.	18
25	Stack OCV test.	19
26	OCV Test.	19
27	Lifting eyes: High pressure compartment.	21
28	Inspect threads.	21
29	Lifting eyes: Low pressure compartment.	22
30	Lifting eyes installed.	22
31	Attaching chain to lifting eyes.	22
32	Battery connector and cable.	23
33	Battery spacer.	23
34	Lifting strap and overhead guard.	23
35	Fuel cell installation.	24
36	High pressure compartment access panel.	24

Contents

List of Figures

Figure	Title	Page
37	Storage tank solenoid valve.....	25

Safety information

The following safety precautions must be observed at all times when operating the fuel cell power system.

NOTE: The following symbols and terms indicate safety information in this manual:



Indicates a hazardous situation that will lead to personal injury or death.



Indicates a hazardous situation which, if not avoided, could result in death or serious injury.



Indicates a hazardous situation which, if not avoided, could result in minor or moderate injury and property damage.

General Information

General hazards, warnings, and cautionary statements

WARNING

Fuel cells are heavy and can cause injury. **DO NOT** put hands, arms, feet or legs between the fuel cell and a solid object.

WARNING

Before connecting the fuel cell, make sure the key or keyless switch is in the OFF position and the parking brake is set.

WARNING

Make sure the capacity of the crane and adjustable 4-point lifting chain is greater than the weight of the fuel cell. The weight of the fuel cell is shown on the fuel cell nameplate.

WARNING

The replacement fuel cell must fit the battery compartment area correctly. Adjust the front spacer plate to prevent fuel cell movement in the battery compartment. Make sure that the fuel cell voltage and weight of the replacement fuel cell are correct as shown on the Nameplate.

1. Read this manual and other relevant documentation in its entirety before operating this equipment. This manual provides specific guidelines for proper installation of the fuel cell system.
2. Ensure that all operators are trained in the proper use of these systems. Provide all operators with a copy of this manual and the fuel cell system operator manual for reference before installing the system.

CAUTION

There are hot surfaces, rotating parts, and hazardous electrical equipment inside the enclosure that could cause burns, cuts, and other injuries. Do not service if any covers are loose or missing.

3. Before installation, perform an inspection of the system to eliminate unwanted material that can hinder operation of the system or create a hazardous situation.
4. **Removal and installation of the fuel cell must be facilitated by a Nuvera approved service technician. All lifting equipment including the lifting eyes and lifting eye fasteners must be provided by Nuvera.**

General Information

5. **DO NOT perform any maintenance or repairs on the fuel cell system. All maintenance should be performed by an authorized service provider or a Nuvera Fuel Cells LLC. representative.**
Unauthorized maintenance or repairs without proper certifications and training could result in a hazardous situation. Unauthorized maintenance or repairs may also void all warranties on the system.
6. If the fuel cell system appears damaged, broken, or unsafe to operate for any reason, do not install. Contact your authorized local service provider.
7. If a hazardous situation is discovered with the fuel cell system, such as an external or internal fire or large escape of flammable gas, do not install. Contact your authorized local service provider.
8. The fuel cell system is for indoor use only. Not rated for high humidity, wet, or rainy conditions.
9. Do not spray or power wash the fuel cell system with any liquids.
10. The fuel cell system is not rated for use below -4°F (-20° C) or above 113°F (45°C). Do not store or leave unattended in freezer.
11. The fuel cell system uses oxygen from the area in which it is being used, and should not be used in areas of tight construction with inadequate air ventilation.
12. Use only with NFPA Type E or Type CGH industrial electric trucks.

CAUTION

Fuel cells must be discarded according to local environmental regulations. Please contact Nuvera for additional information.

About the Nuvera® Fuel Cell System

Components of the Nuvera® Fuel Cell System

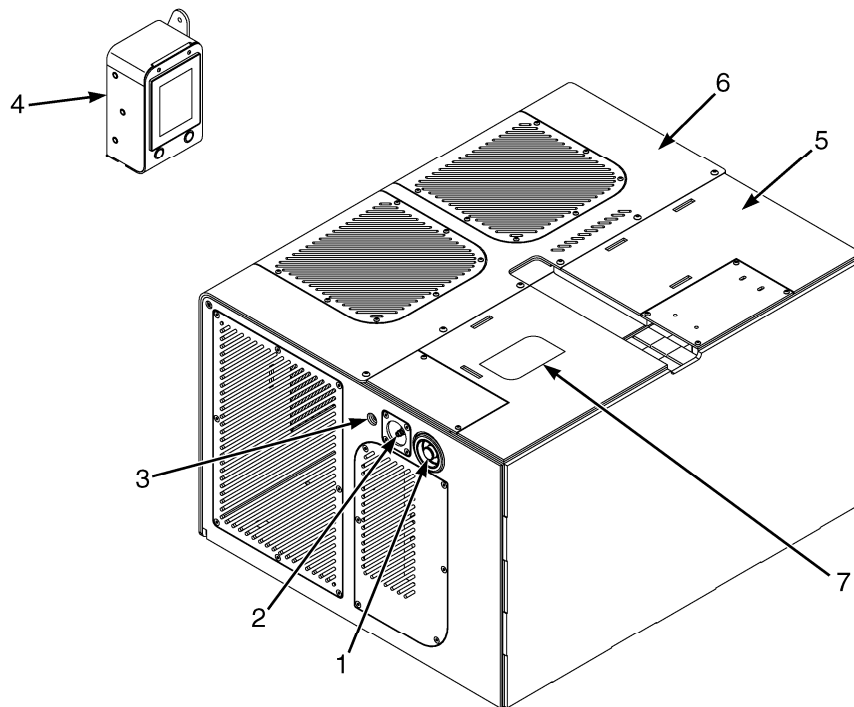

BC990029

Figure 1. External fuel cell system components

Item	Component	Component Description
1	Fueling connector port	Contains a fitting for attaching the dispenser nozzle during fueling.
2	Dewatering connector port	Contains a fitting for attaching the dewatering hose.
3	Dispenser interface connector	Contains a connector for the dispenser interface cable.
4	Human-Machine Interface (HMI)	Allows the operator to monitor functions of the fuel cell system from the truck operator compartment.
5	High pressure (Fuel) compartment	Also called the fuel compartment. Houses the hydrogen gas storage tanks, plumbing and control devices.
6	Low pressure compartment	Houses the fuel cell stack sub-system, pumps and other components, thermal management, hybrid power system, and power electronics.
7	Nameplate	Contains information such as model number, serial number and other specifications.